

SLIDING DOOR: ASSEMBLY & INSTALLATION SERIES 1200

V2020.1

Subject to technical changes.

CONTENT AND TOOLS

CONTENT:

Content and tools	page	02
Product information	page	03
Manual	page	05
Accessories	page	06
Detail drawings	page	08
Assembly instruction	page	11
Installation instruction	page	15

TOOLS:

(without claim of completeness)

- Hack saw
- Allen key set
- Cordless drill
- Drilling machine
- Drill set metal / stone
- Screwdriver set
- Rubber mallet
- Pencil
- Water level

VERSION INFORMATION:



- Version 1.4: Middle guiding added
- Version 1.5: Handle half-round / no longer available
- Version 1.6: Top track straight added
- Version 1.7: Bottom and top track dimensions adjusted
- Version 1.8: Handle square, 40 x 115 mm

PRODUCT INFORMATION

Preparation

This manual is part of the product and describes the safe and proper installation of the system. Please read the instructions carefully before installation.







Please note that the assembly should only be done by qualified and trained staff in strict compliance with all details indicated in this document.

Improper installation in variation from manufacturer's specification may cause defects and danger, thus endangering the safe fixing of the product as well as the safety of the prospective user. The liability of the manufacturer shall be excluded in case of defects and consequential damages resulting from incorrect assembly of this product.

Please check the completeness of the delivered parts and check carefully if any transport damages are visible.

If any parts are damaged or lost, please immediately contact the responsible supplier. It is assumed that you have exactly identified all cutting dimensions according to the measurement instruction for raumplus products.

SYMBOLS:

Symbol	Importance
	Risk or danger
	Advice and information
	Additional information / other documents
	Directional data / direction of movement
	„yes“ and „right“
	„no“ and „wrong“
	

System Information: S1200

n max. weight of element	=	396lbs [180kg]
n min. / max. door height	=	27 1/2" / 137 3/4" {700 mm / 3500 mm}
n min. / max. door width	=	19 3/4"/70 3/4" [500 mm / 1800 mm]

PRODUCT INFORMATION

GENERAL INFORMATION:

Product safety

The door system complies with the prior of the art and the authorized safety rules at the time of delivery.

USE:

Intended use

The prerequisite for the intended use of our products is the professional installation according to our installation instruction. Sufficient fittings must be available and durably attached to all relevant places.

The function of the fitting must not be hindered or altered during installation.

Special solutions are only possible in consultation with raumplus.

Use not as intended

Risk or danger may occur in the following cases:

- the door system has improperly been installed or maintained
- the safety and installation instructions have not been followed.
- after improper installation or inadequate fixing (e.g. to parts of buildings)
- the maximum weight of the doors has been exceeded.
- improper shock and case loads or other additional loads on the fittings have occurred
- the fittings have been used outside.
- body parts or objects got into the closing edges or door runnings during use of the door wing.
- the door system is not used as intended.

Structural modifications

structural modifications that are not offered as an accessory from raumplus may only be attached or installed with permission of raumplus GmbH!

MANUAL

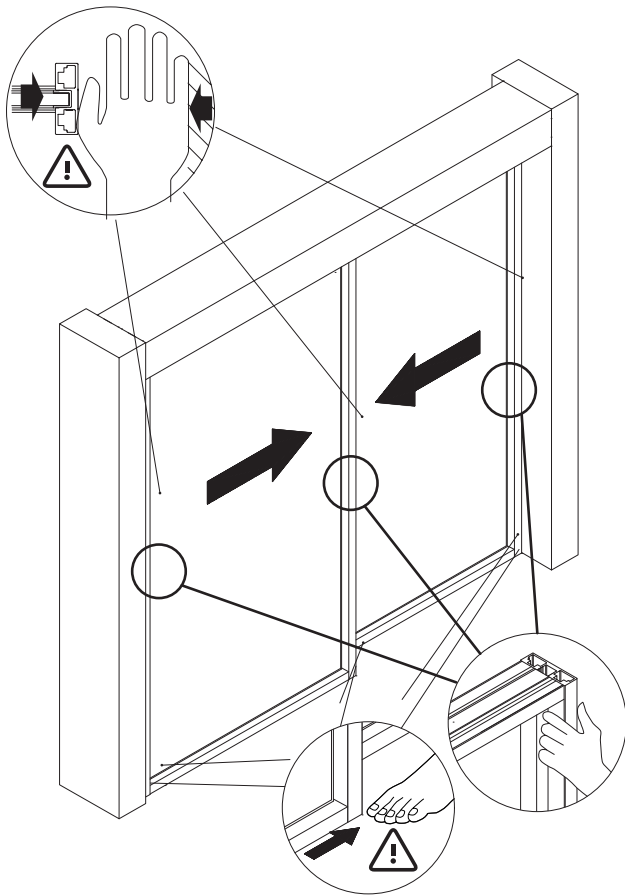

Designated use::

The product is designed and manufactured for indoor use. The product was designed as a hand-held sliding door that is usually not moved faster than at walking pace and that is braked manually when reaching of the end position. The doors are guided at the top and at the bottom.

Any other use or use beyond that is considered to be improper.

Manual:

Open the door by the handle profile or the handle (optional).

Run the door slowly to the ...
... opening / closing point, or
... activating point of the sliding door brake (optional).

Note:

Protect your hands from jamming during the movement of the door. When closing or opening the door never grasp the profile, only use the handle profile or the handle. Use the door as instructed.

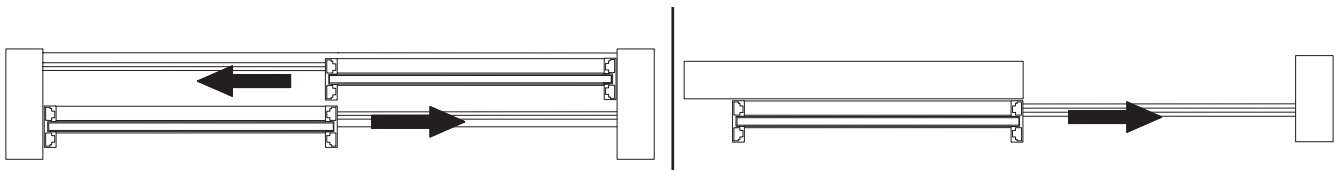

Safety Information:

The product complies with the prior art and the recognized safety rules at the time of delivery.

- Pay attention to child safety.
- No additional load to the doors.
- Structural changes, additions or modifications can only be carried out by a dealer.
- In case of malfunctions or irregularities: shut down the system and contact your dealer.
- Installation of the product without wall connection, only in combination with top / bottom stopper



As defined in the „Law of Liability for Products“ (§4 Prod-HaftG), for the liability of the manufacturer, for his products, the above information has to be regarded. The disregard of this manual, releases the manufacturer from his liability.

ACCESSORIES



Profiles and visible fittings are available in following colours:

- silver - black mat - white - dark bronze - light bronze -

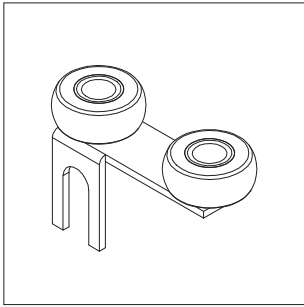

1_ 10.01.013

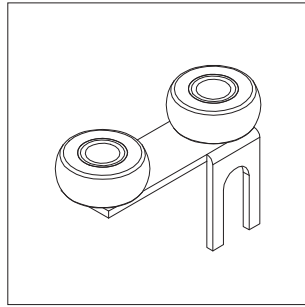

2_ 10.01.014

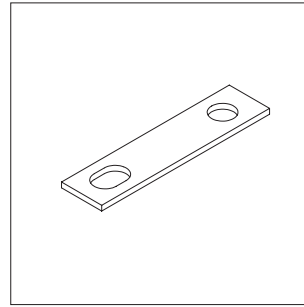

3_ 10.01.070

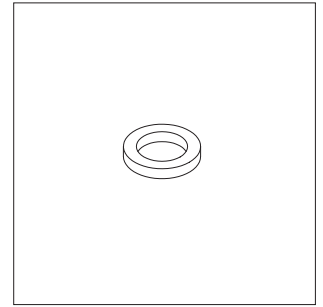

4_ 10.07.215

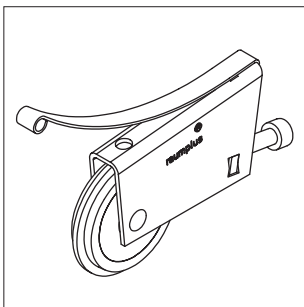

5_ 10.01.120

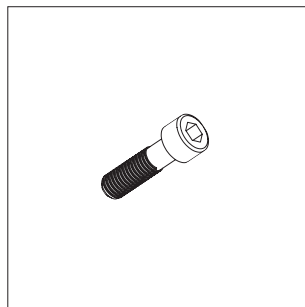

6_ 10.01.12x

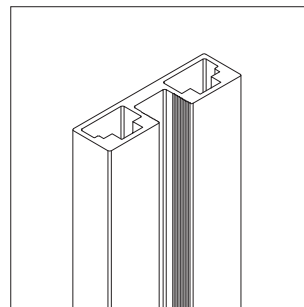

7_ 12.01.0xx

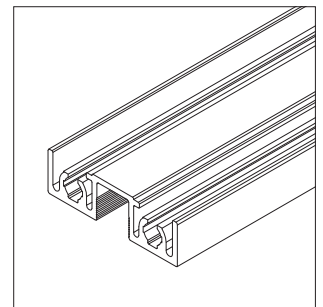

8_ 12.02.0xx

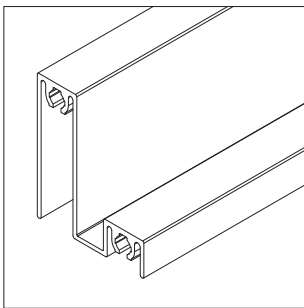

9_ 12.04.0xx

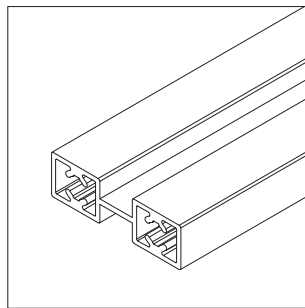

10_ 12.20.0xx

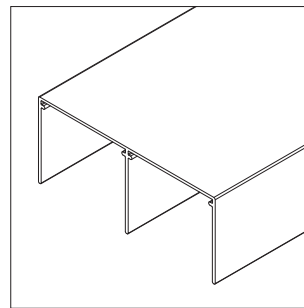

11_ 12.05.0xx

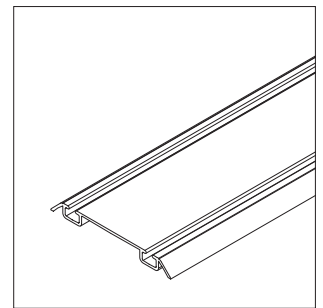

12_ 14.08.0xx

1_ top roller S 1200 left

2_ top roller S 1200 right

3_ reinforcement f.punching holes

4_ washer f. div. rail connection

5_ bottom roller, screw

6_ screw f. bottom roller

7_ stile S 1200

8_ top rail S 1200 for SD

9_ bottom rail S 1200 f. SD

10_ dividing rail insert S 1200

11_ Deckenschiene 2 L S 42 gerade

12_ top track double S 42, straight

bottom track doub.,surf.closed

ACCESSORIES

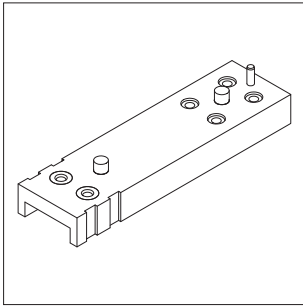

13_ 30.14.018

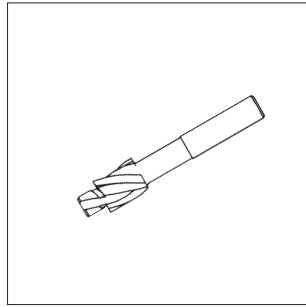

14_ 30.14.020

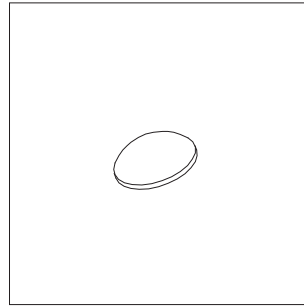

15_ 20.08.566

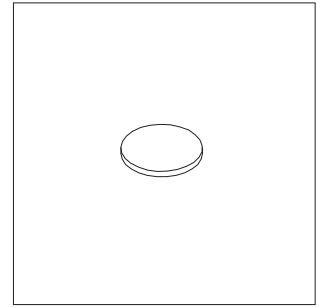

16_ 20.08.56x

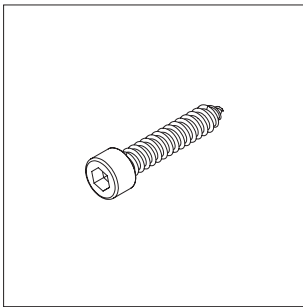

17_ 10.07.xxx

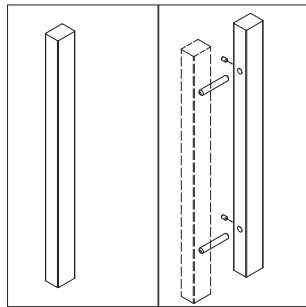

18_ 10.01.9xx / 10.01.94x

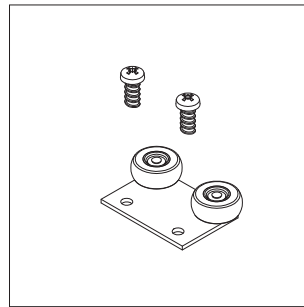

19_ 10.01.019 /
10.01.007

13_ drilling template for S 1200

14_ countersink set w. guiding pin S 1200

15_ bump stop transparent

16_ plugs f. profile service

17_ frame screws 6,3 x 32 mm

18_ handle rectang., self-adhes. / handle rectang. (backside) for

19_ top roller wooden door S 42 middle guiding
tapping screw DIN 7981 4,8 x 9,5

w / o fig.

20_ lenshead screw

21_ gasket all series, (transparent)

22_ gasket all series, (dark)

23_ 4 mm gasket for dividing rail, (transparent)

18_ 4 mm gasket for dividing rail, dark

10.01.909

10.07.03x

10.07.13x

10.07.042

10.07.142

DETAIL DRAWING

EXPLODED DRAWING

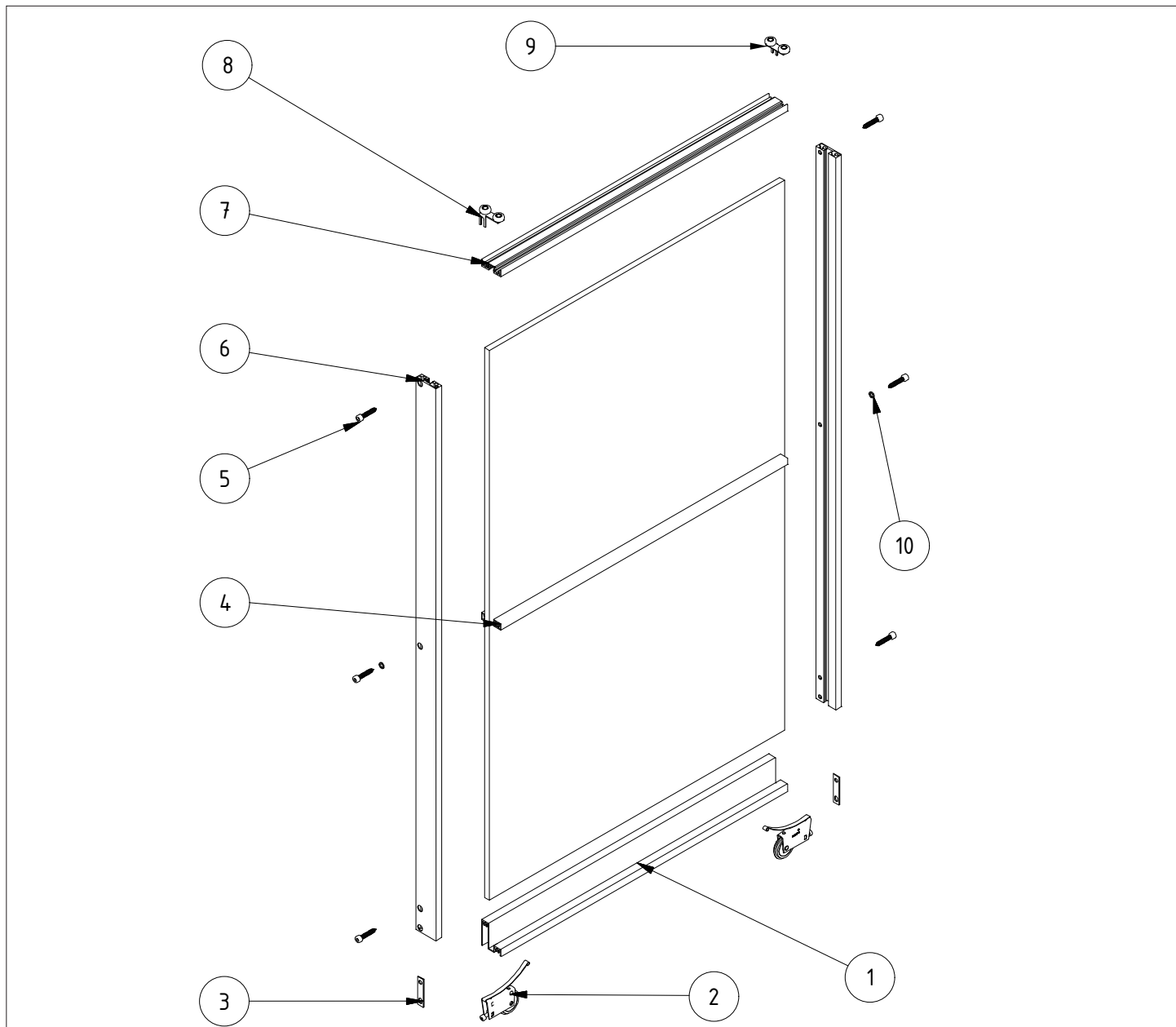

Item list			
object	quantity	item	item no.
1	1	bottom rail S1200 f. SD	12.04.0xx
2	2	bottom roller	10.01.120
3	2	reinforcement f. punching holes	10.01.070
4	1	dividing rail insert S1200	12.20.0xx
5	6	frame screw 6.3 x 32mm	10.07.21x
6	2	stile S1200	12.01.0xx
7	1	top rail S1200 for SD	12.02.0xx
8	1	top roller S1200 left	10.01.013
9	1	top roller S1200 right	10.01.014
10	2	washer f. div. rail connection	10.07.215

1_ Sliding door S1200

DETAIL DRAWING

HOLE PATTERN VERTICAL PROFILES / CUTTING MEASURES

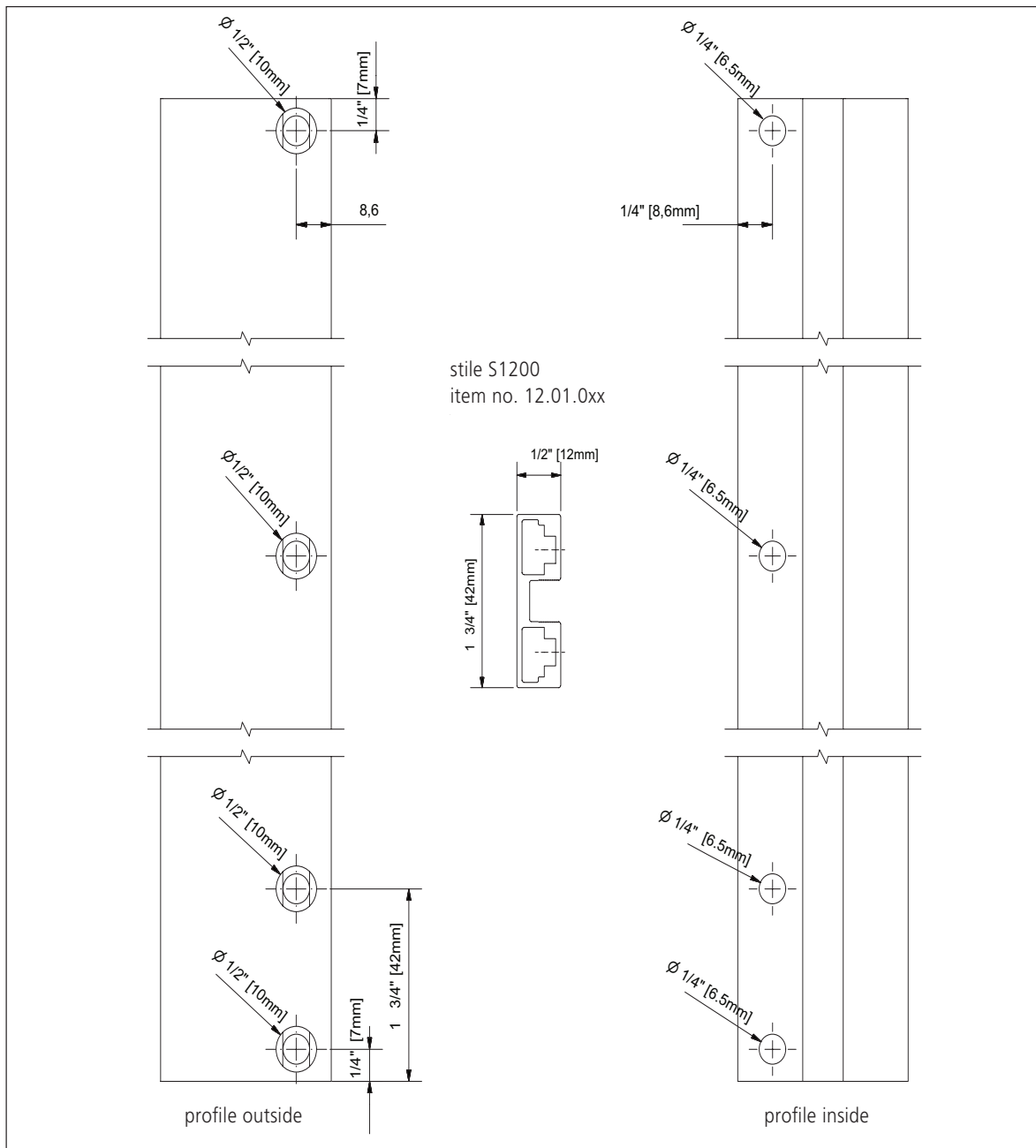

CUTTING MEASURES S1200 sliding door:

Door height = clear height - 1 3/4" [45 mm]
 Cross rail length = door width - 1" [24 mm]
 min. / max. door width = 19 3/4" / 70 3/4" [500 mm / 1800 mm]
 min. / max. door height = 27 1/2" / 137 3/4" {700 mm / 3500 mm}
 max. door weight = 396 lbs [180 kg]
 Overlap = 1/2" [12 mm]

CUTTING MEASURES PANEL S1200 sliding door

(w/o dividing rail):

Panel height = door height - 1/4" [6 mm] wood
 = door height - 1/4" [7 mm] gasket
 Panel width = door width - 1/2" [11 mm]

1_ Hole pattern stile S1200

CUTTING MEASURES

S1200 SLIDING DOOR / PANEL

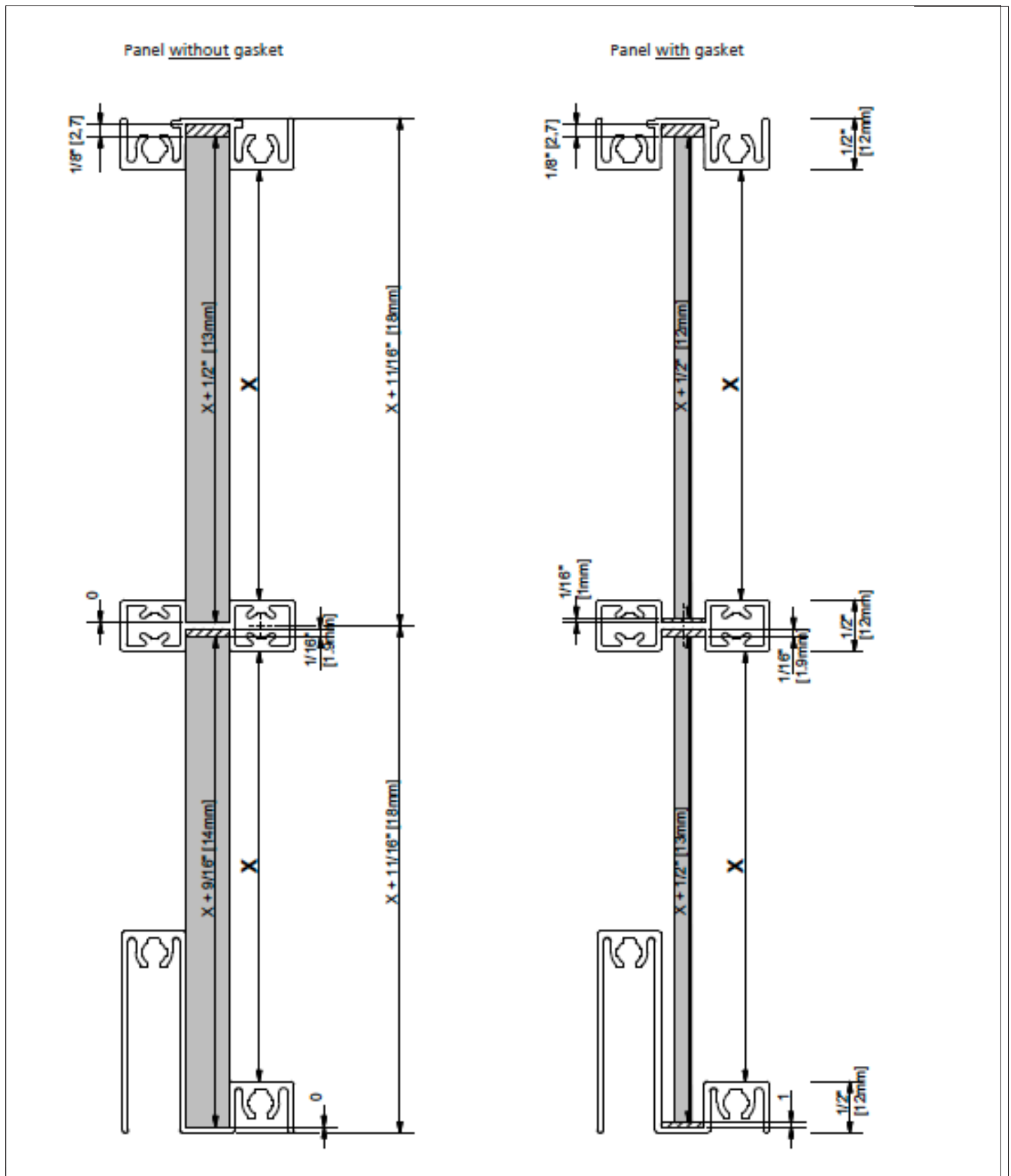

CUTTING MEASURES

S1200 SLIDING DOOR / TRANSVERSE PROFILES

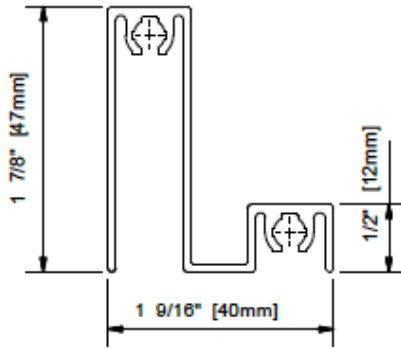

bottom rail S1200 f. SD
item no. 12.04.0xx

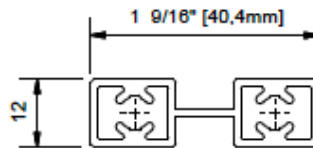

dividing rail insert S1200
item no. 12.20.0xx

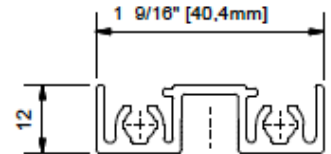

top rail S1200 for SD + AIR
item no. 12.02.0xx



Please consider the overlap for the 2-track and 3-track systems.

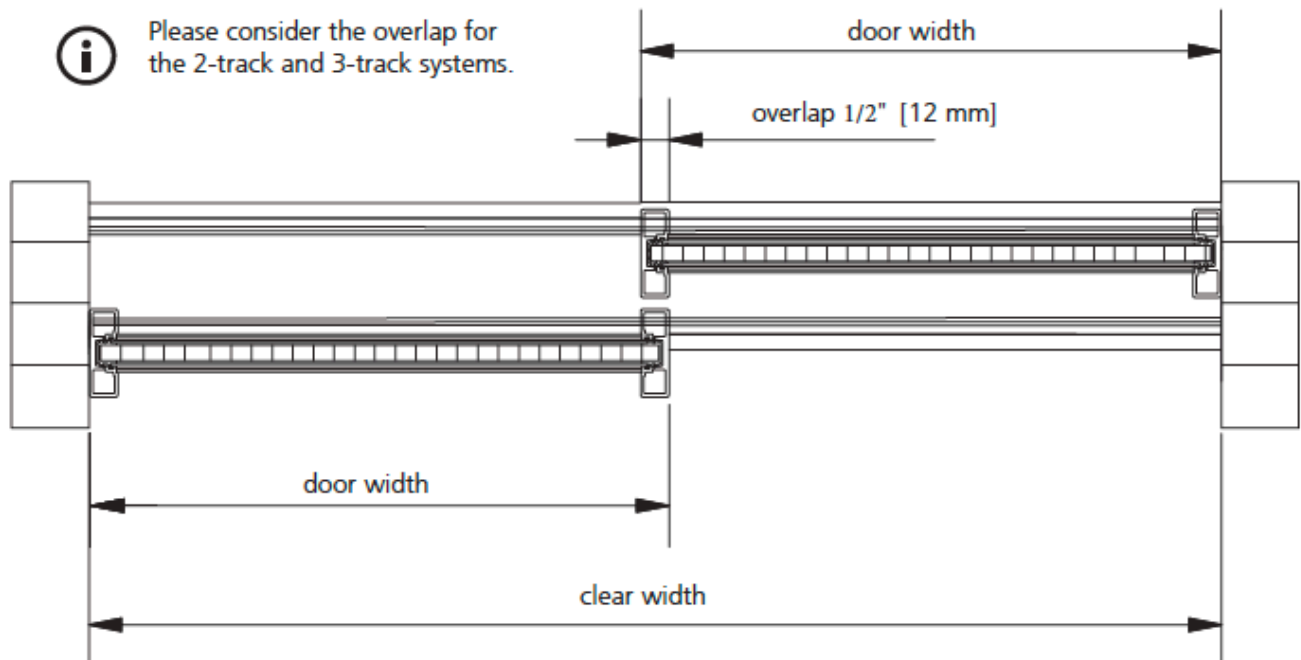

ASSEMBLY INSTRUCTIONS

DOOR PANEL / GASKET

i The gasket is only necessary for glass panels under 10 mm.

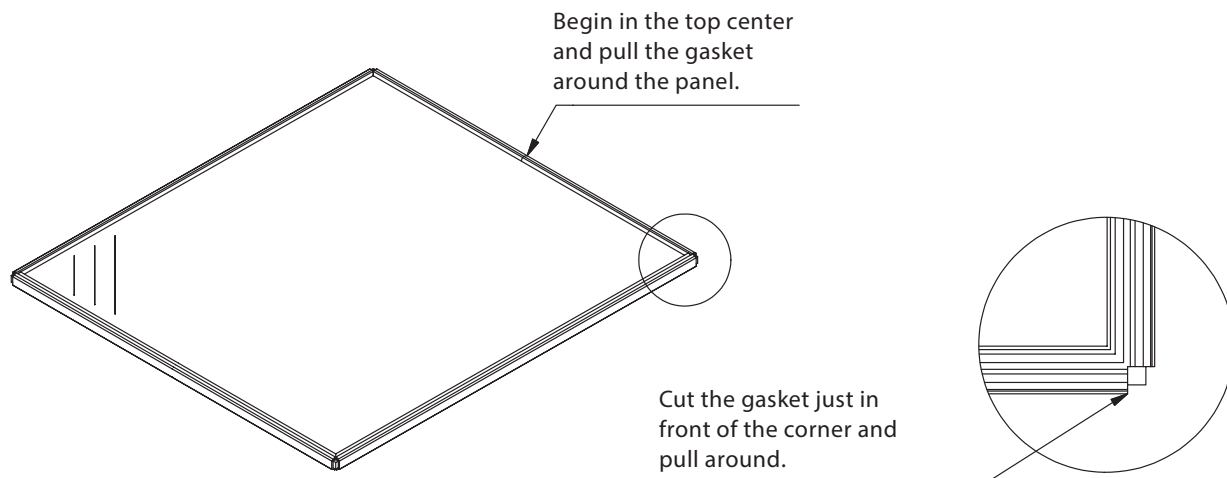

1_ Panel

i After the profiles mounted on the glass filling, cut the stick out from the gasket at the rail.

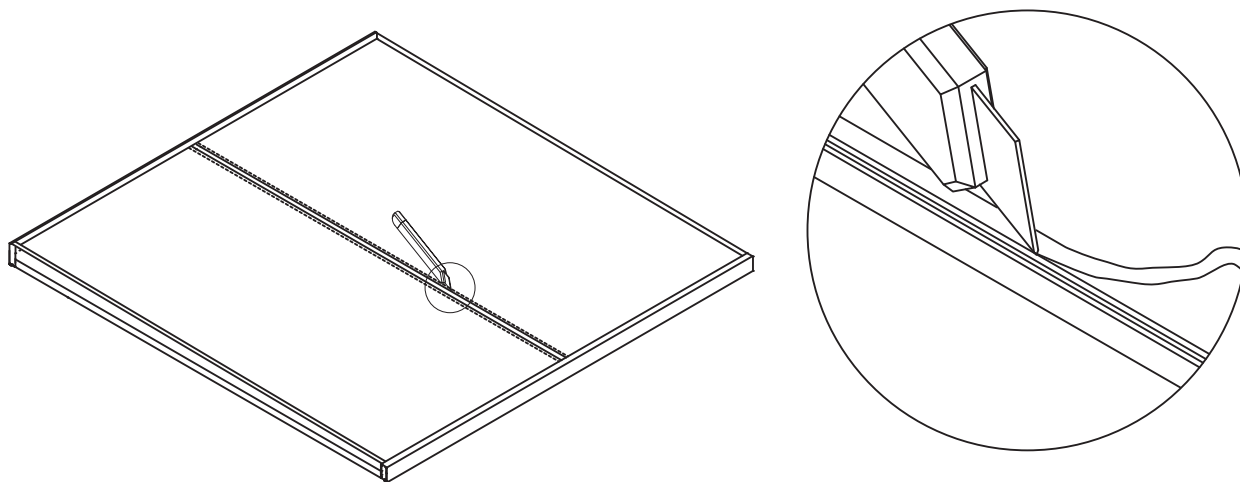

ASSEMBLY INSTRUCTIONS

SLIDING DOOR / ASSEMBLY

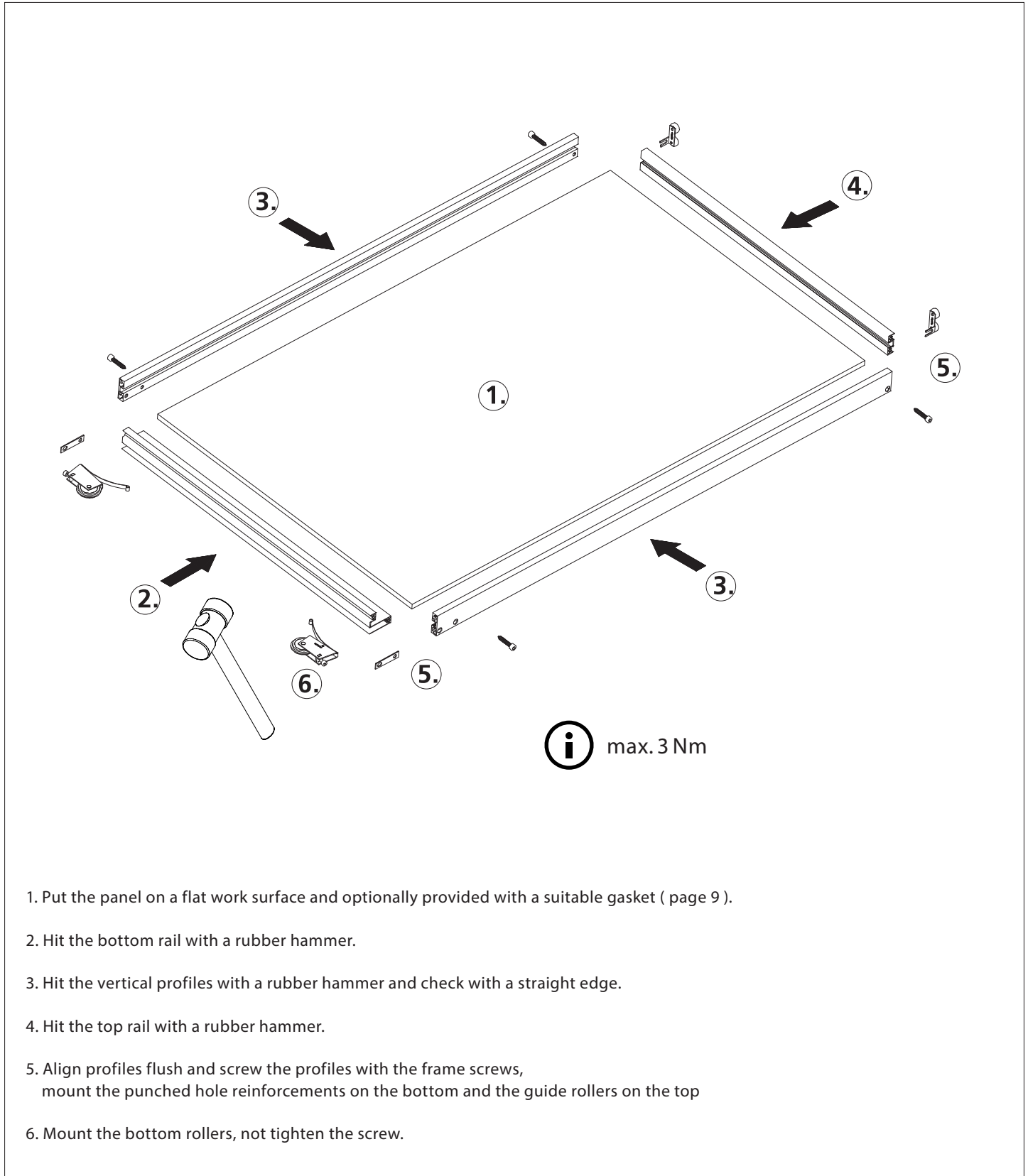

ASSEMBLY INSTRUCTIONS

SLIDE DOOR ASSEMBLY / FRAME SCEWS

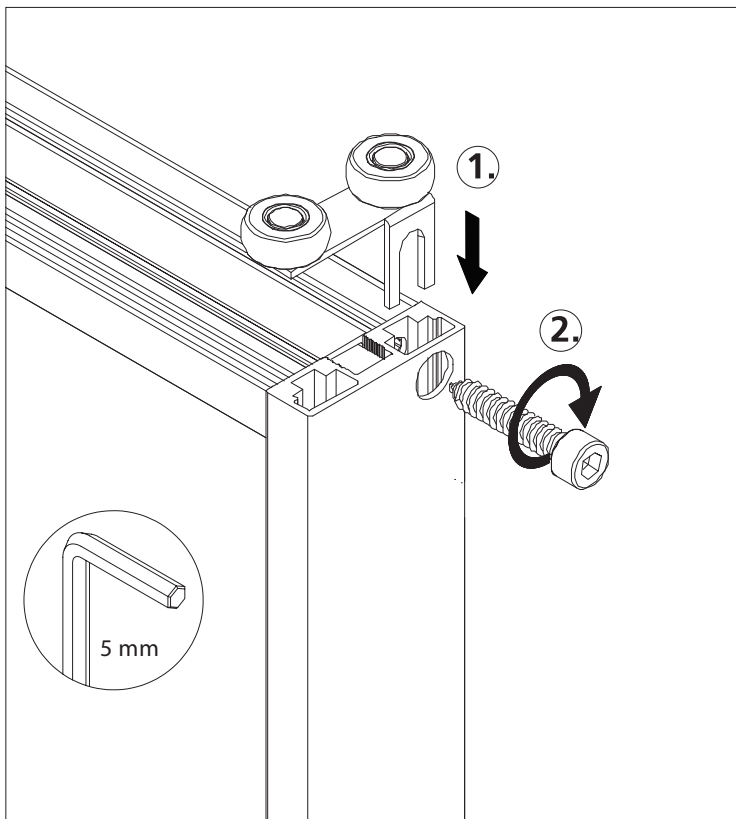

1_ Assembly of the top rollers (max.3 Nm)

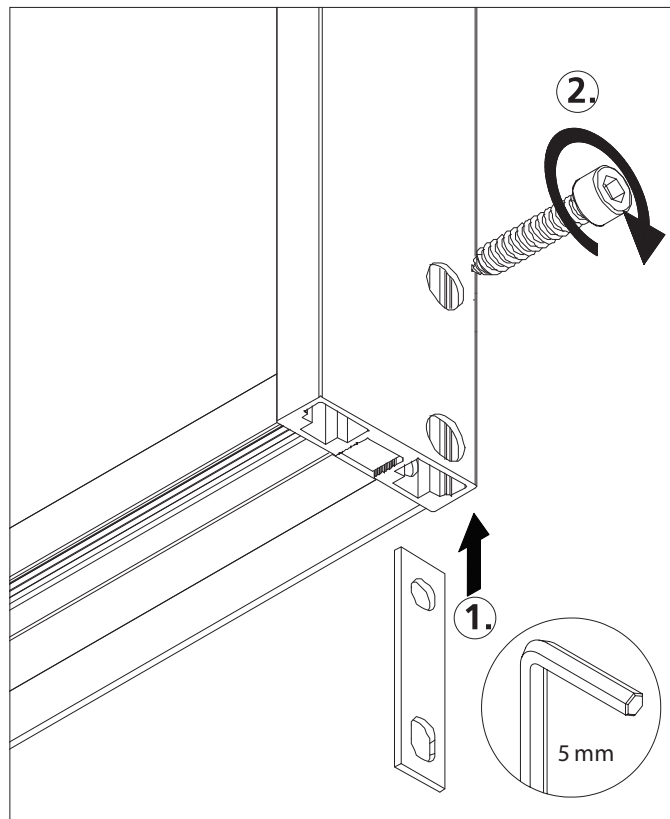

2_ Inserting the reinforcement for punching holes (max.3 Nm)

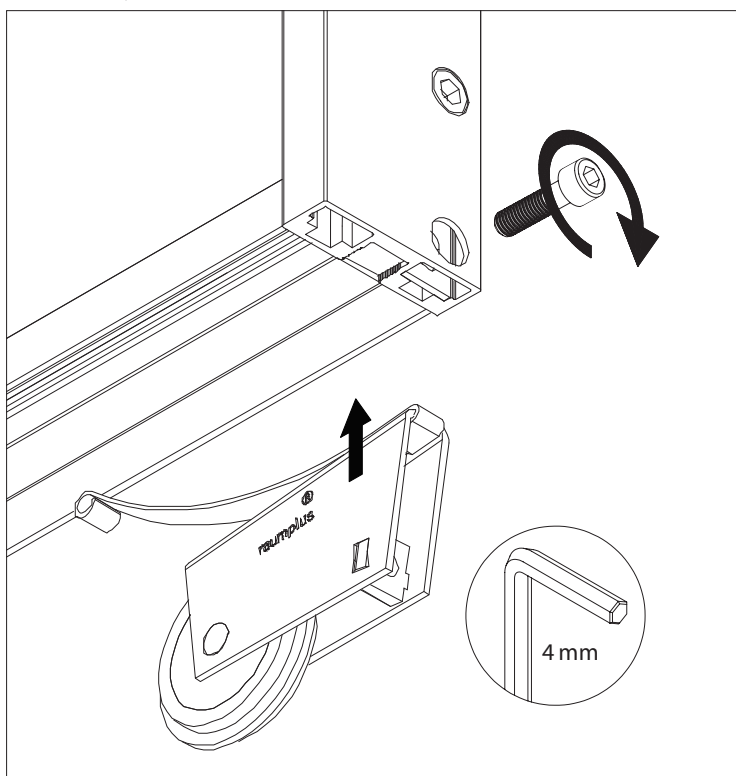

3_ Assembly of the bottom rollers

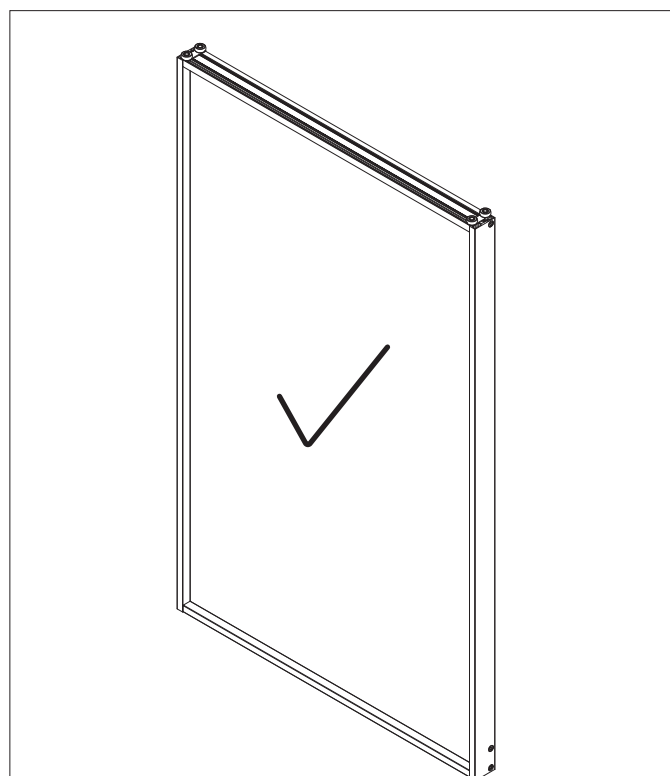

4_ Sliding door S1200 is completed.

INSTALLATION INSTRUCTION

PREPARE / INSTALL TOPTRACK

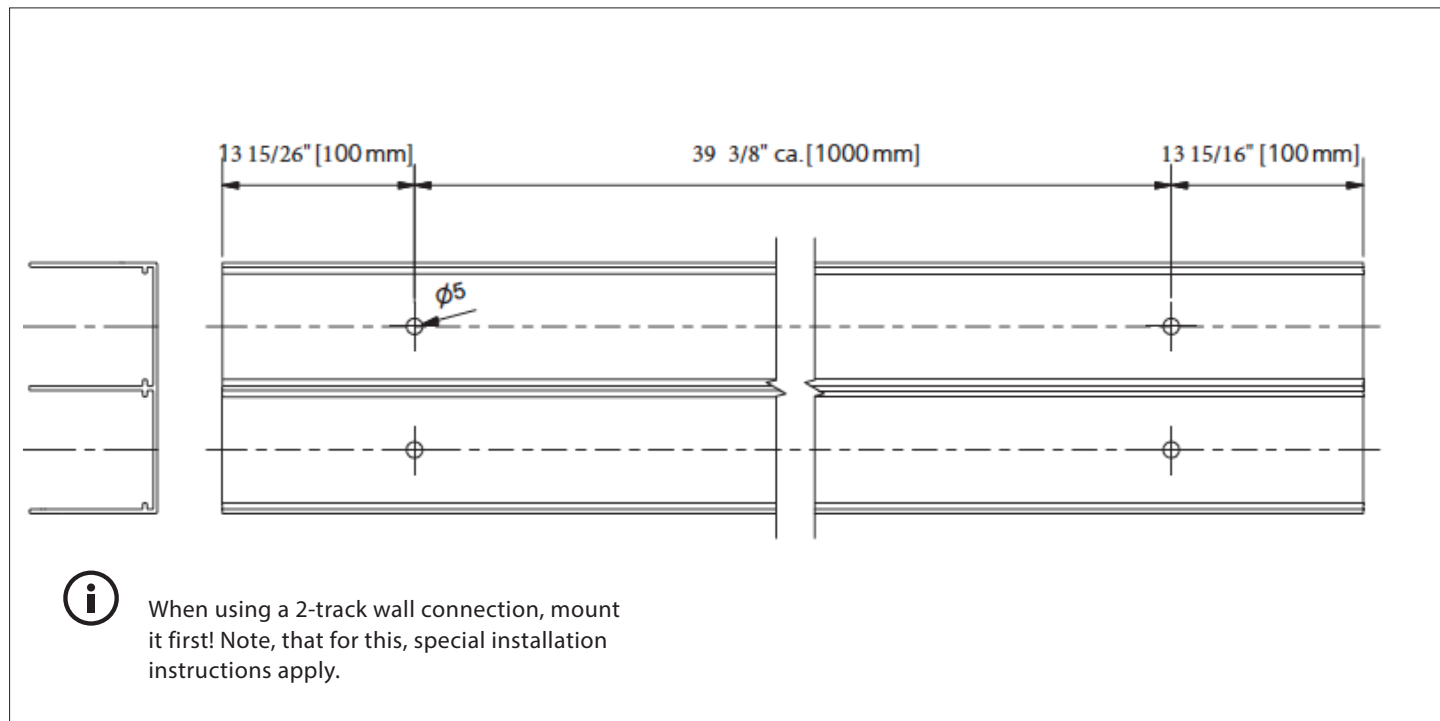

1_ Cut the top track to size and drill.

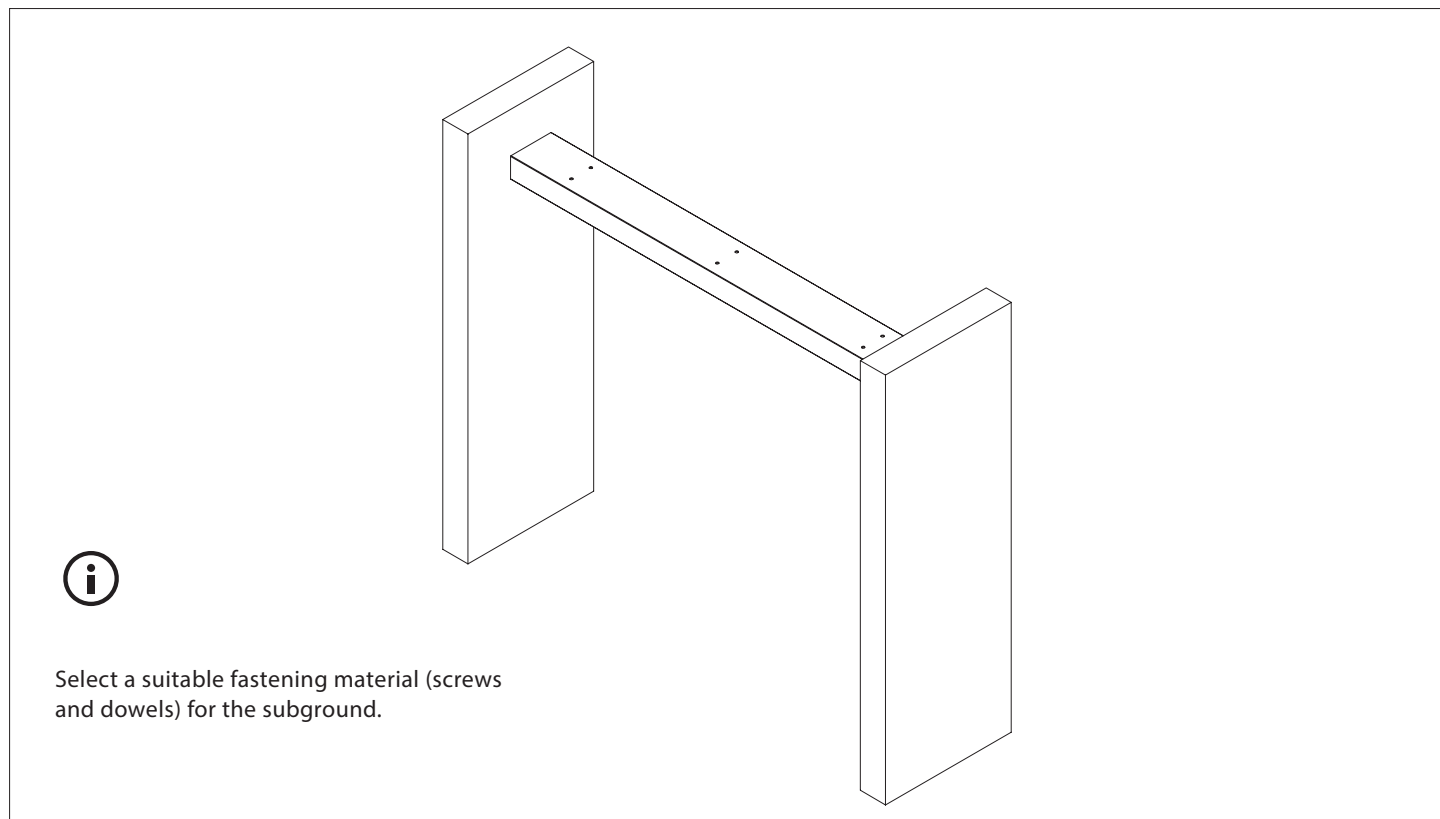

2_ Drill holes in the ceiling and mount (fig. excluding ceiling).

INSTALLATION INSTRUCTION

PREPARE / INSTALL BOTTOM TRACK

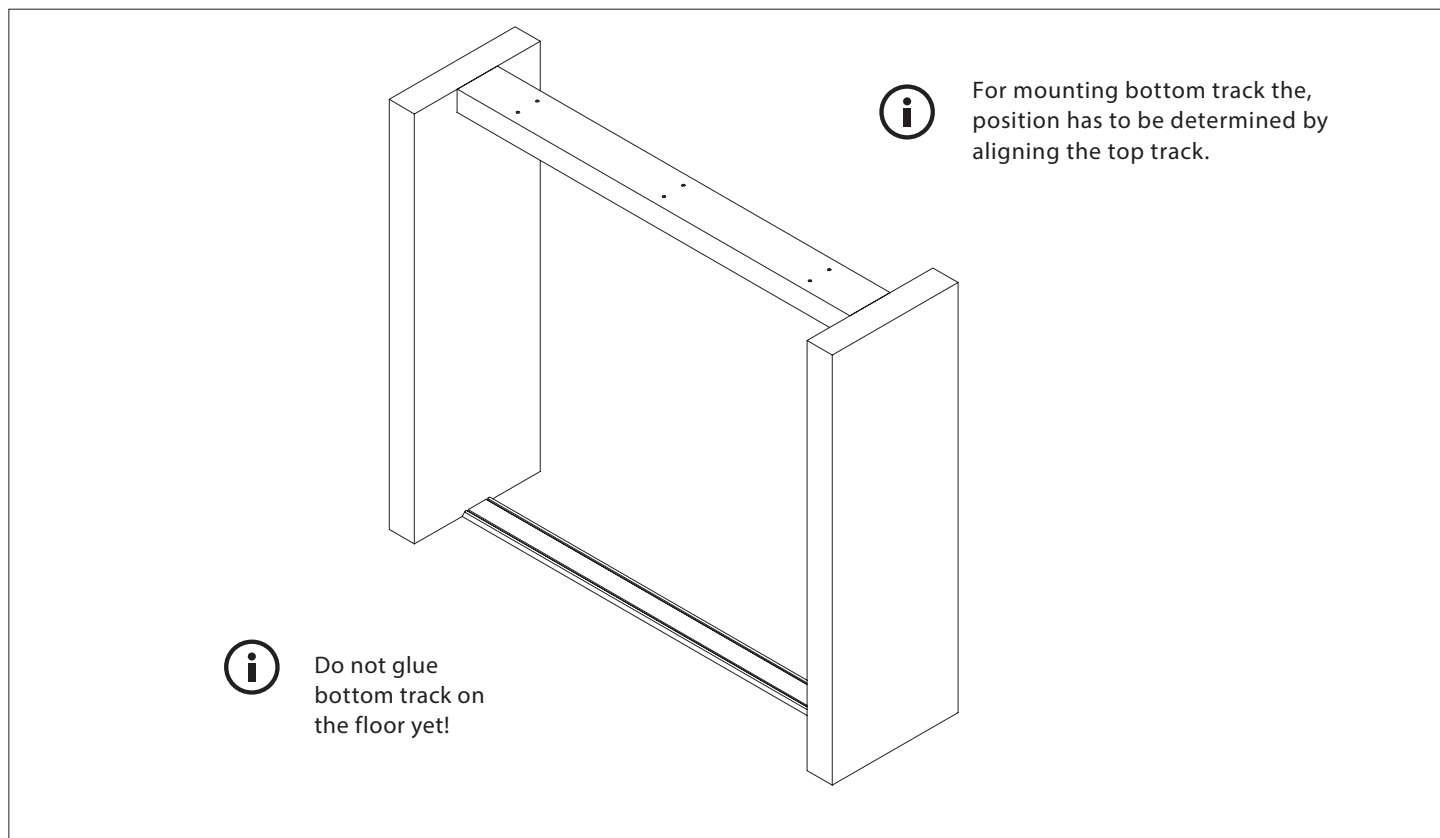

1_ Cut the bottom track to size and position it under the top rail.

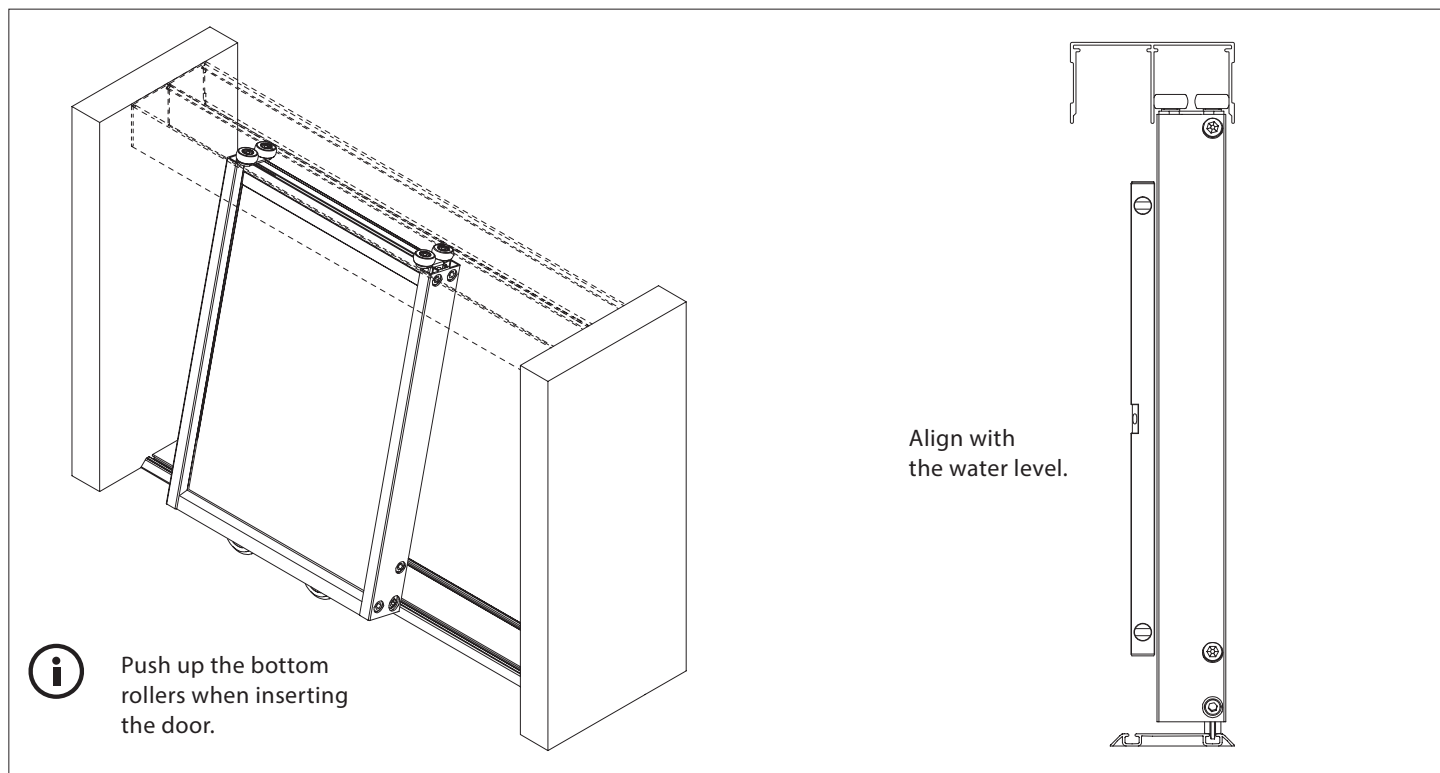

2_ Insert door and align vertically by moving the bottom track, mark the position with adhesive tape.

INSTALLATION INSTRUCTION

INSTALL BOTTOM TRACK



When using an insert bottom track, all carpets, laminates or tiles have to be cut in order to fit in the bottom track.
Before assembling the bottom track, please move the bottom stopper into the roller guide of the track and make sure the stopper is inserted correctly.

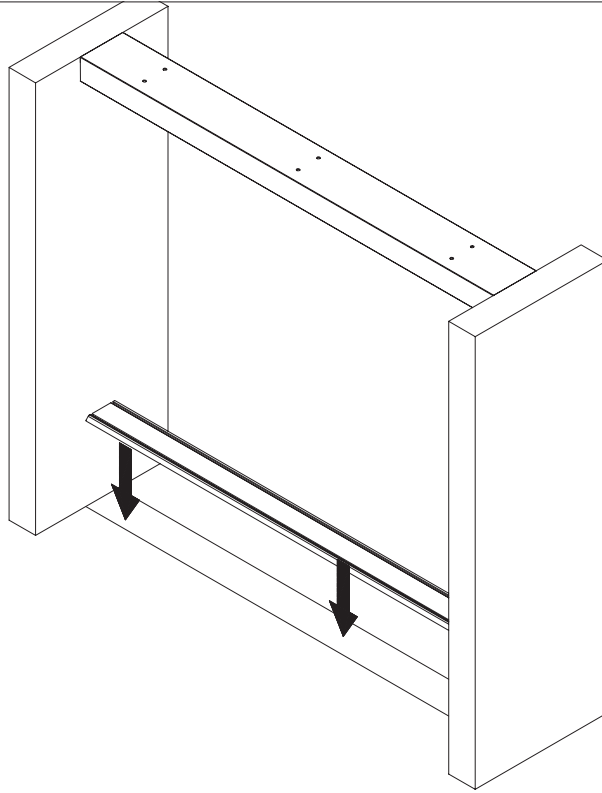

1_ Remove the sliding door, clean adhesive surfaces and glue the bottom track on the labeled position.

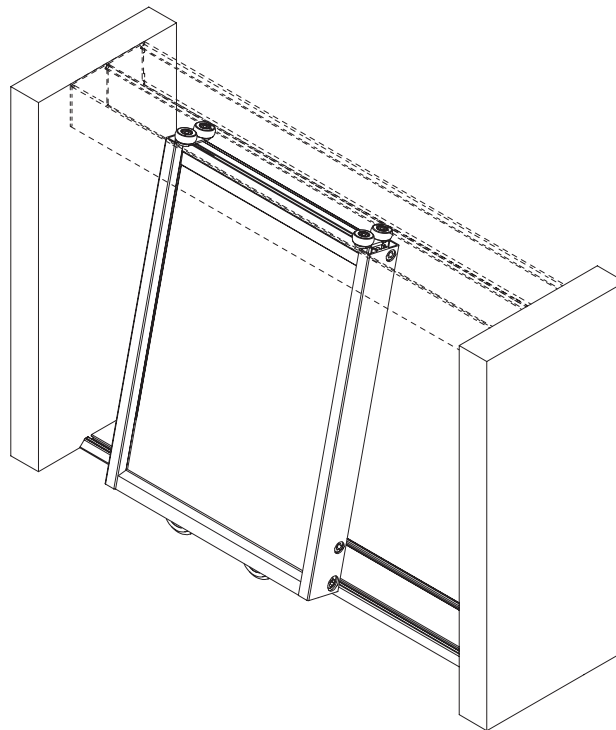

2_ Reinsert sliding door.

INSTALLATION INSTRUCTION

ADJUST SLIDING DOOR

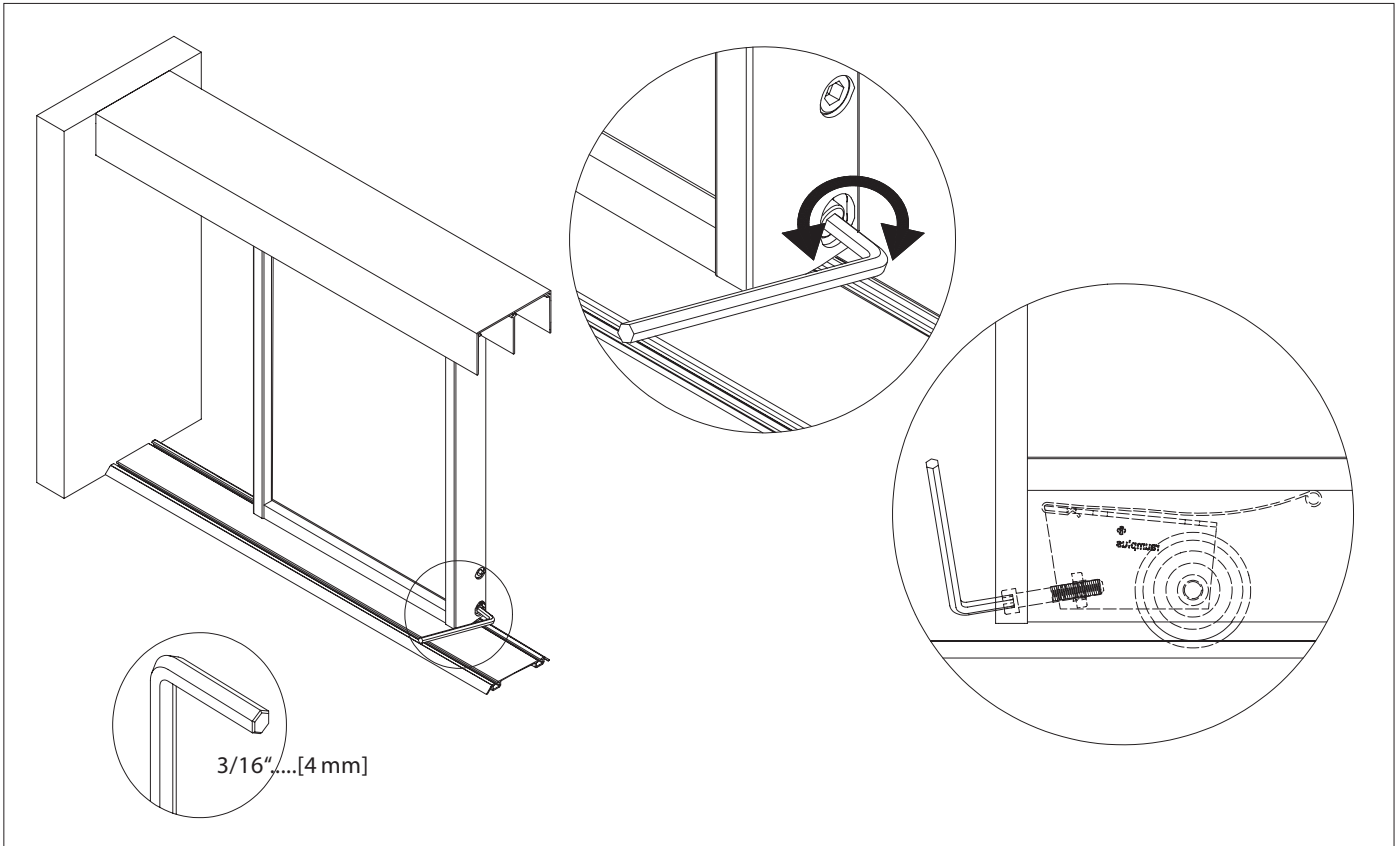

1_ Adjust sliding door

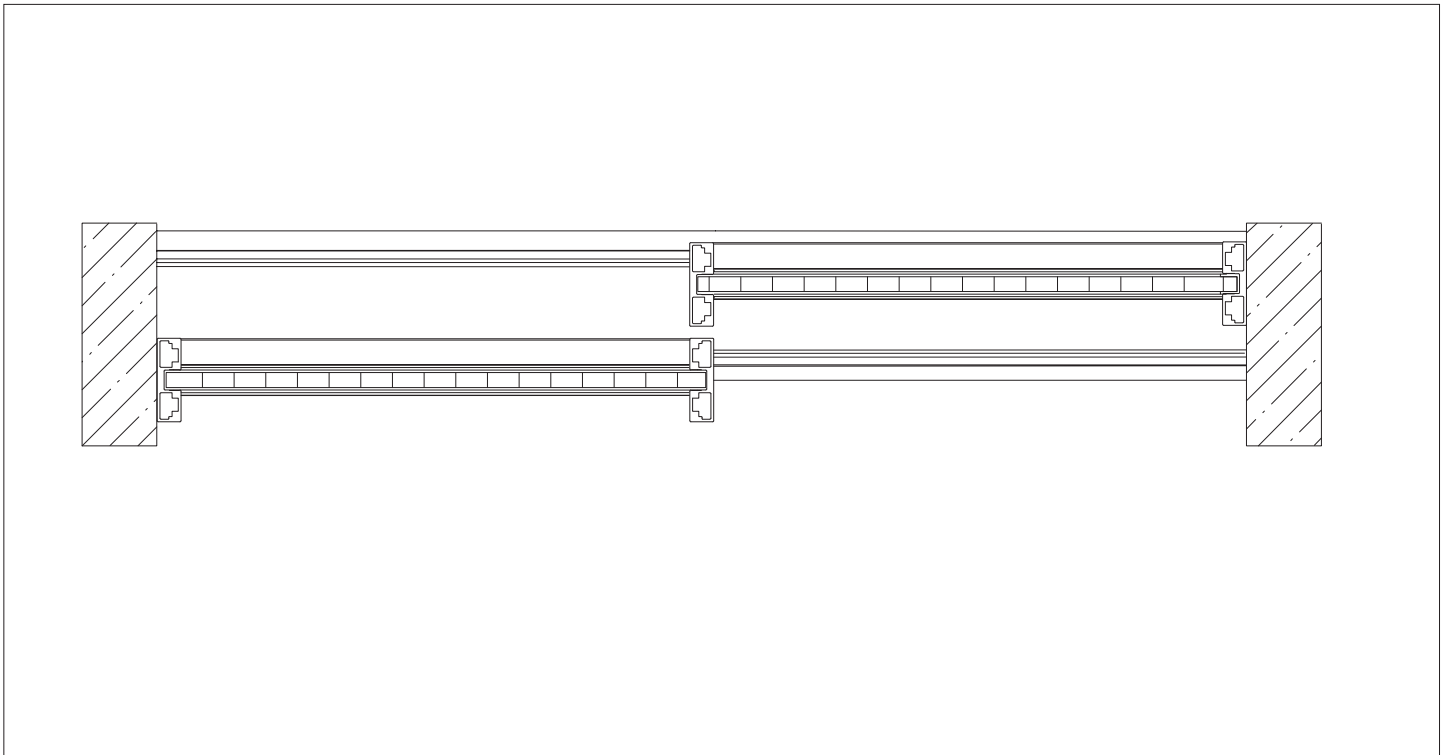

2_

DETAIL DRAWING

BOTTOM TRACKS S42

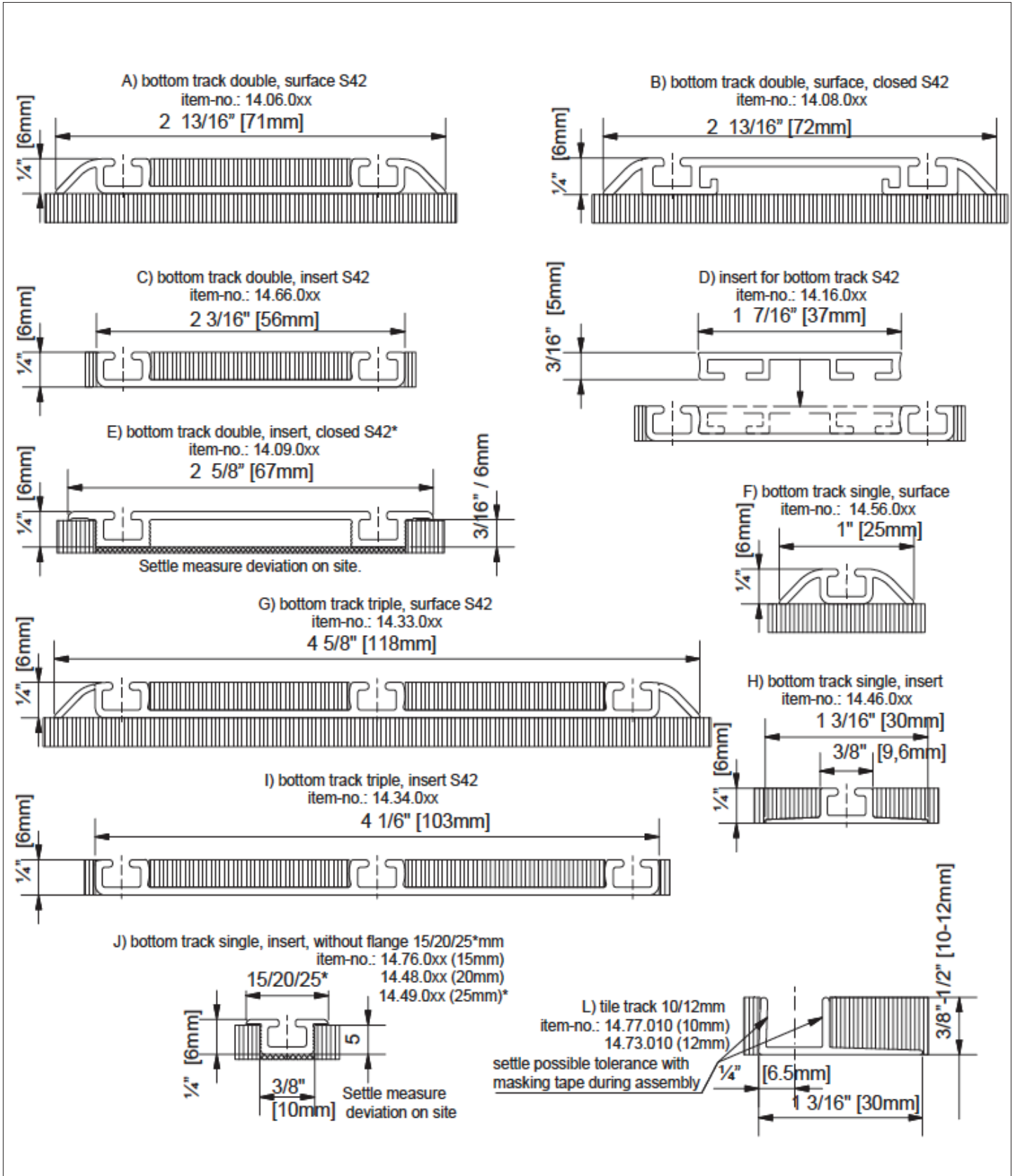

DETAIL DRAWING

POSITION BOTTOM TRACKS S42

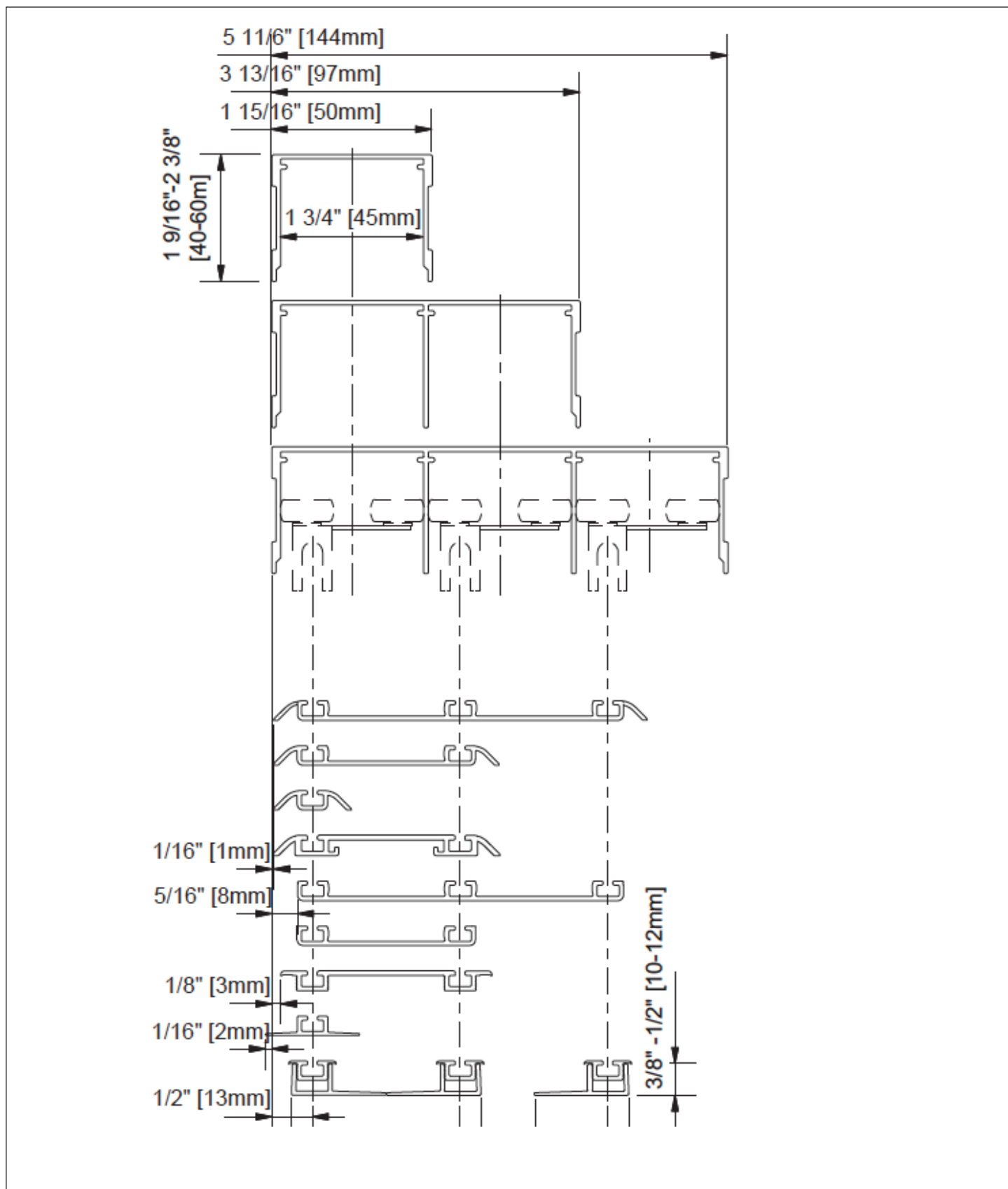

DETAIL DRAWING

SECTION S1200

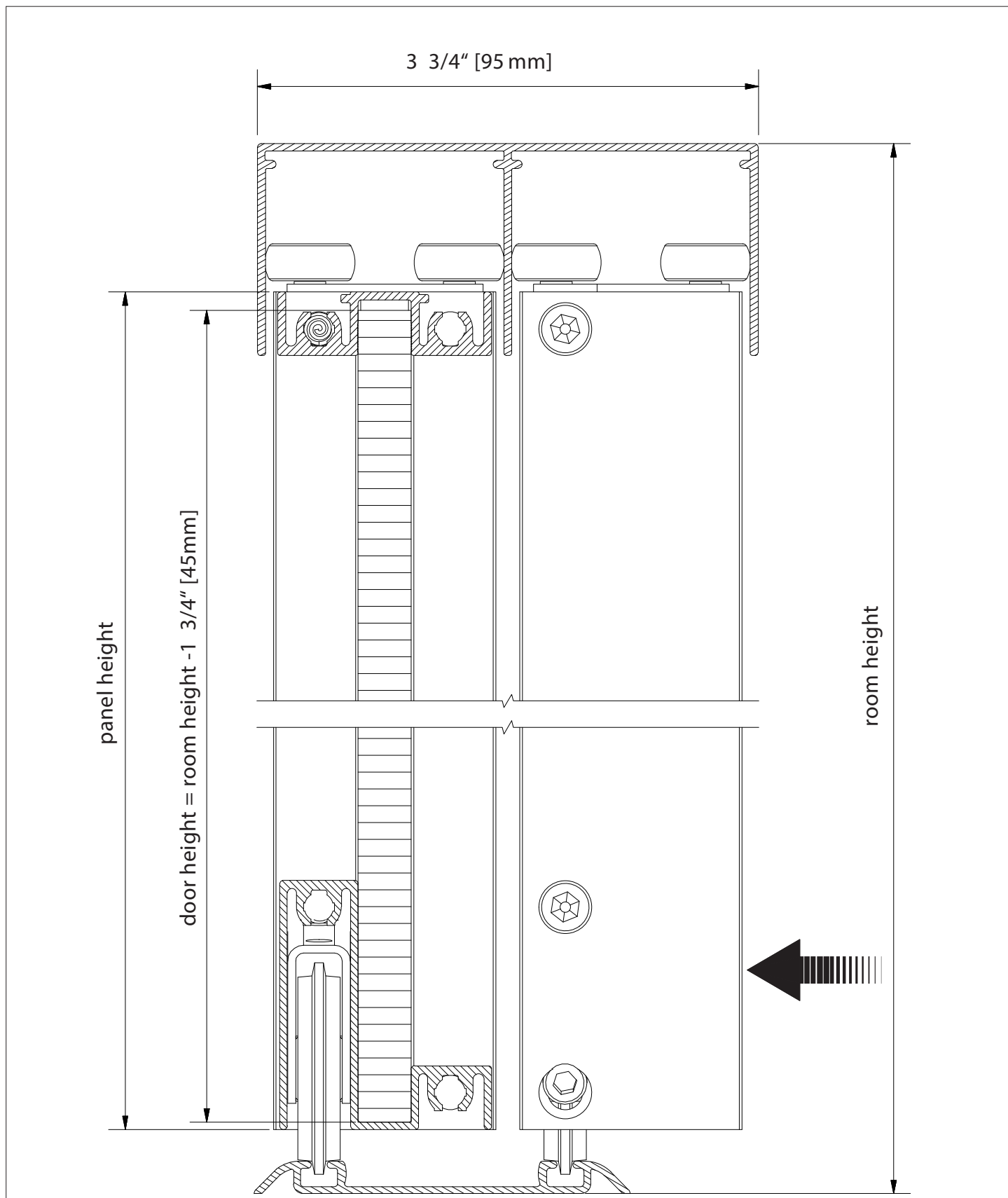

DETAIL DRAWING

HANDLE / DIVIDING RAIL

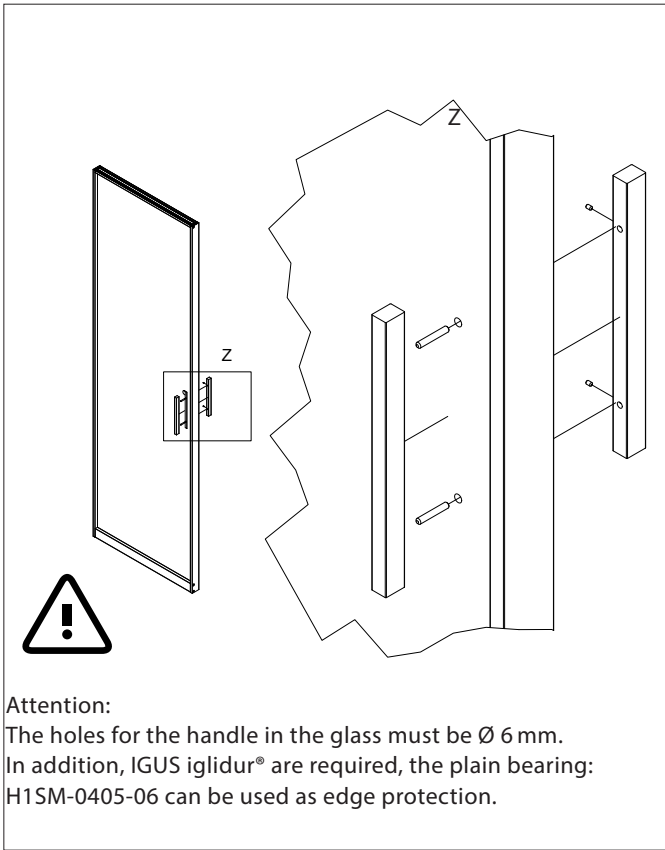

1_ The handle can be glued or screwed

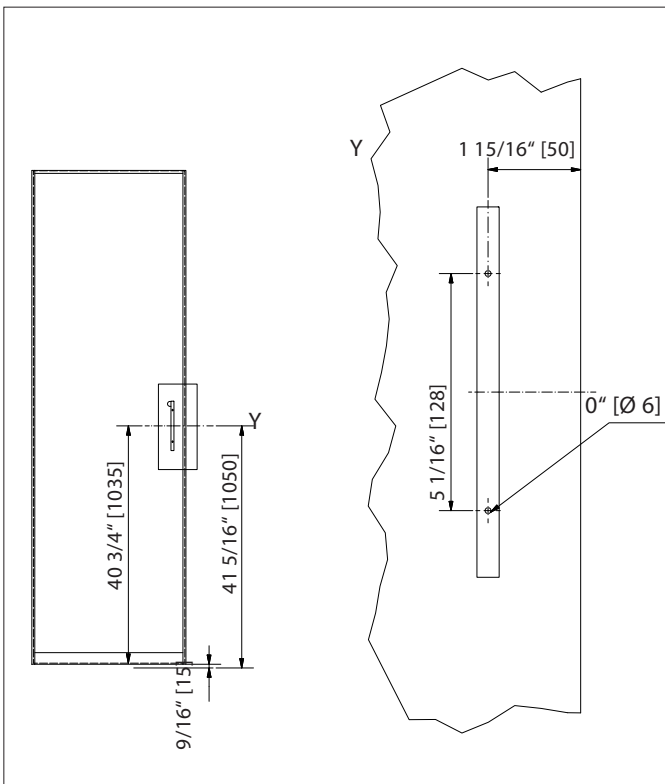

1_ Handle square 1 9/16" x 4 1/2" [40x115 mm]

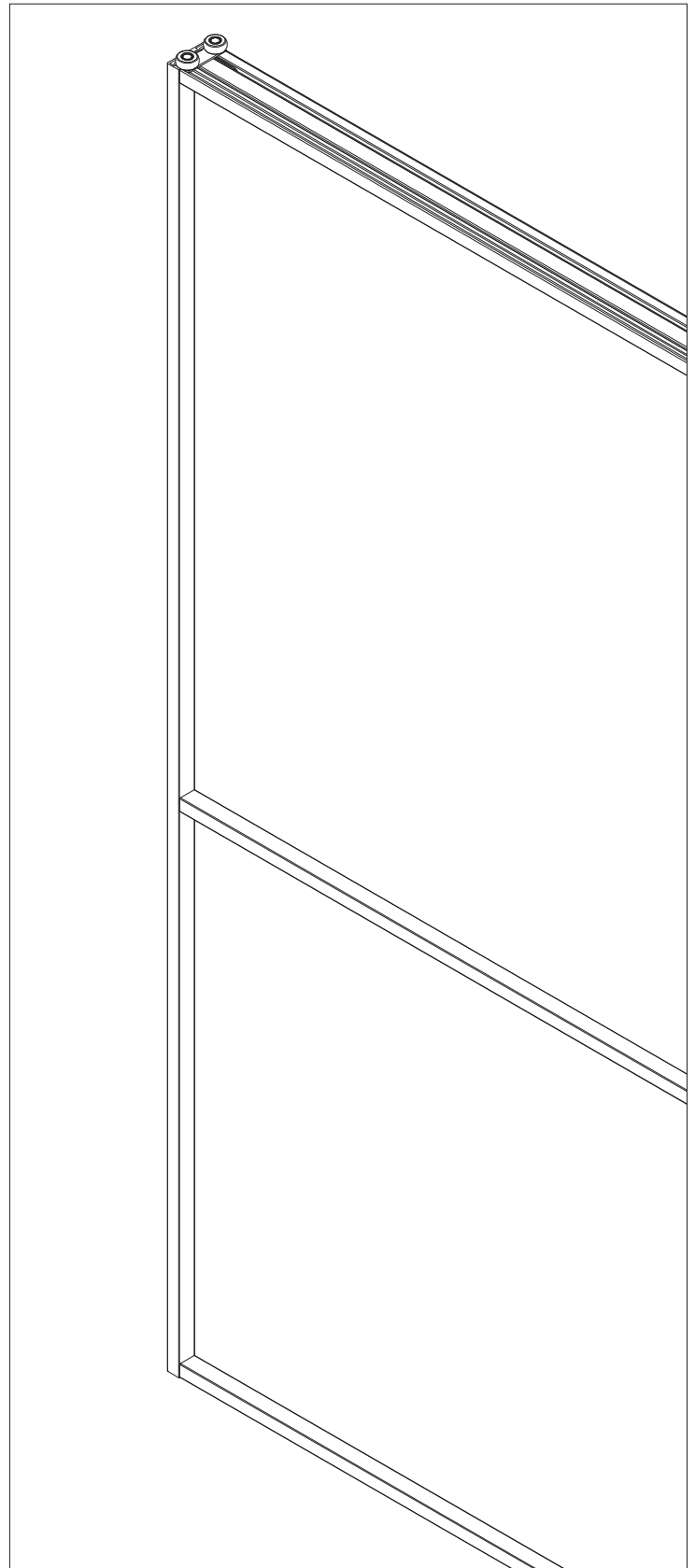

2_ Dividing rail