

SLIDING DOOR SYSTEM_ S1200 AIR

TECHNICAL BOOK

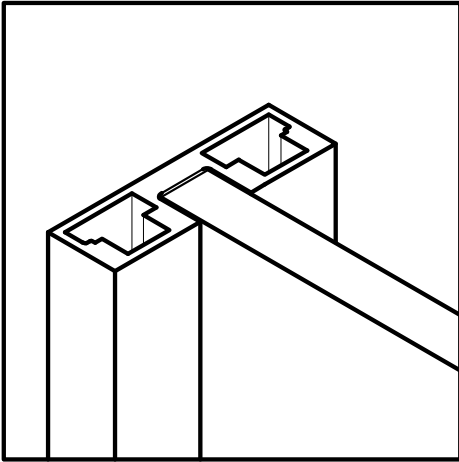

System description

Accessories

SYSTEM DESCRIPTION_ S1200 AIR

SLIDING DOOR SYSTEM

SLIDING DOOR SYSTEM_ AIR SERIES S1200

- 1.0_ System description_ page 03
- 2.0_ Profile_ page 04
- 3.0_ System description, fixed_ page 06
- 4.0_ Profile. fixed_ page 07
- 5.0_ Accessories, fixed_ page 08
- 6.0_ Detail, fixed_ page 08
- 7.0_ Diagram, fixed_ page 09
- 8.0_ Profile finishes_ 10
- 9.0_ Panels_ page_11
- 10.0_ Top tracks_ page 13
- 11.0_ Accessories_ page 15
- 12.0_ Diagrams_ Alignment_ page 21
- 13.0_ Diagram_ Recessed top track_ page 24

1.1_ Overview

The key features of our made-to-measure system are versatility in customization and quality of our hardware allowing for individual solutions and unparalleled operation. The AIR system is an ideal solution for environments where an uninterrupted floor plane is required. See profiles for specifics.

Doors can be ordered fully assembled with our standard panel materials or as frame kits to accommodate a panel material of your choosing. Assembly of doors with customer's own materials (COM) is available; please contact Raumplus for more information.

1.2_ Fully assembled door

Made-to-measure per specifications with the following design parameters:

- _ Maximum height 2743mm [9' - 0"]
- _ Maximum width 1219mm [4' - 0"]
- _ Maximum weight 60kg [130lbs]
- _ Standard finish: Clear anodized aluminum (silver)
- _ Top track, Valance, L-bracket shipped 50mm [2"] over-length for trimming on-site

System components (quantity per door):

- Top Track
- 1_ Valance (varies by order)
 - 2_ Top track (varies by order)
- Not shown:
- AIR Stopper with brake (2)
- Door
- 3_ AIR Roller (2)
 - 4_ Fixation for top track (2)
 - 5_ Top rail (1)
 - 6_ Stile (2)
 - 7_ Frame screw (4)
 - 8_ Plug / cover (4)
 - 9_ Brush gasket (one stile only)
 - 10_ Panel (varies by order)
 - 11_ Panel gasket (all sides of panel)
 - 12_ Bottom rail (1)
 - 13_ Ground plate with roller (1)
 - 14_ Ground plate without roller (1)

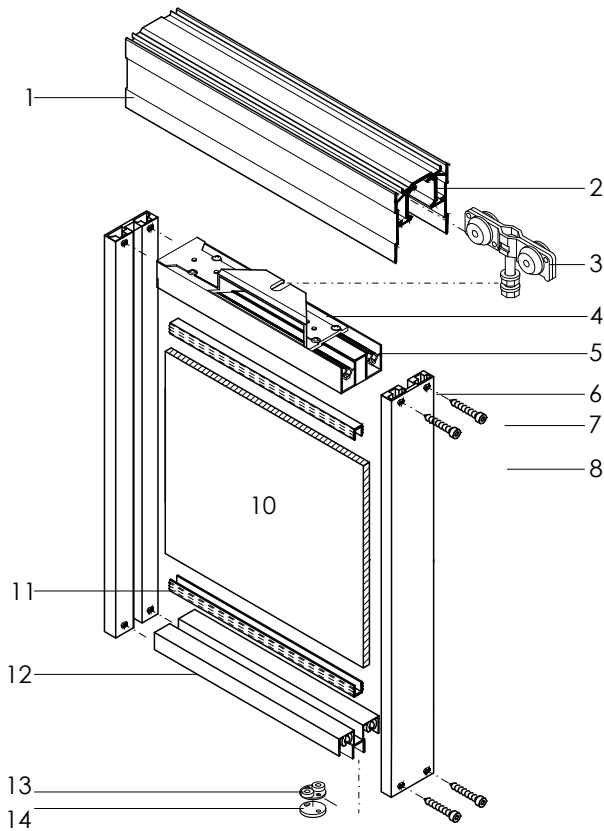

1.3_ Frame kit

Frame kits are made-to-measure per specifications and ready for assembly using customer's own panel material. In addition to the design parameters listed for fully assembled doors, please consider the following:

- _ Minimum panel thickness 4mm [5/32"]
- _ Maximum glass thickness 8mm [5/16"]
- _ Maximum solid panel thickness 10mm [3/8"]

Appropriate panel gasket to be specified when ordering:

- _ 4mm [5/32"]
- _ 5mm [3/16"]
- _ 6mm [1/4"]
- _ 7mm [9/32"]
- _ 8mm [5/16"]

*Gasket not required for solid 10mm [3/8"] material

SYSTEM DESCRIPTION_ S1200 AIR

SLIDING DOOR SYSTEM

2_ Profiles

2.1_ S1200 Isometric view / wall-mounted

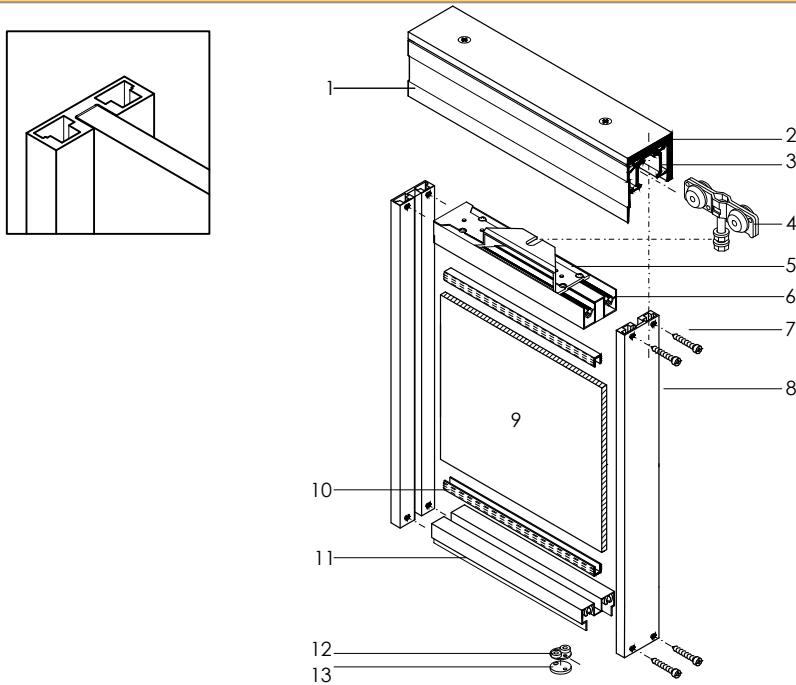

Each sliding door is composed of the following:

Top track

- 1_ Valance (varies by order)
- 2_ Continuous L-bracket (varies by order)
- 3_ Top track (varies by order)

Not shown:

- AIR Stopper with brake (2)
- Door
- 4_ AIR roller (2)
- 5_ Fixation for top track (2)
- 6_ Top rail (1)
- 7_ Stile (2)
- 8_ Frame screw (4)
- 9_ Panel (1)
- 10_ Panel gasket (all sides of panel)
- 11_ Bottom rail (1)
- 12_ Ground plate with roller (1)
- 13_ Ground plate without roller (1)

S1200 Section and stile detail / wall-mounted

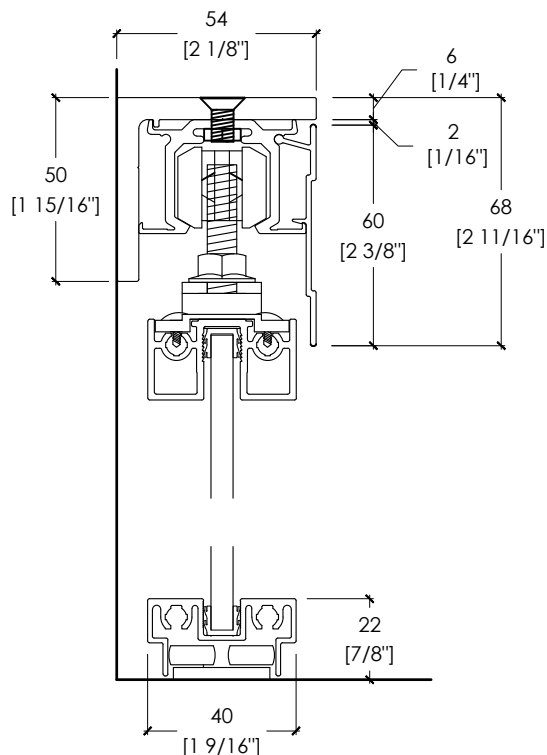

Profile S1200

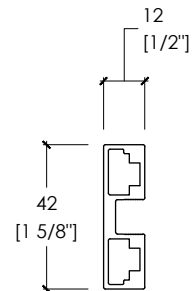

S1200 Stile

- 12.01.022 - Silver
- 12.01.066 - Mat black

Finish

Standard: Clear anodized aluminum (silver), Mat black powder coat

Application

Residential / commercial projects

Dimensions

Max size 1219mm x 2743mm [4' x 9']

Max weight 60kg [130lbs]

Panel thickness 4mm [3/16"] to 10mm [3/8"], 10mm without gasket

*Door can not travel past ground plate with roller

*Wall-mounted, single and bi-parting doors only

2.2_ S1200 Isometric view / ceiling-mounted

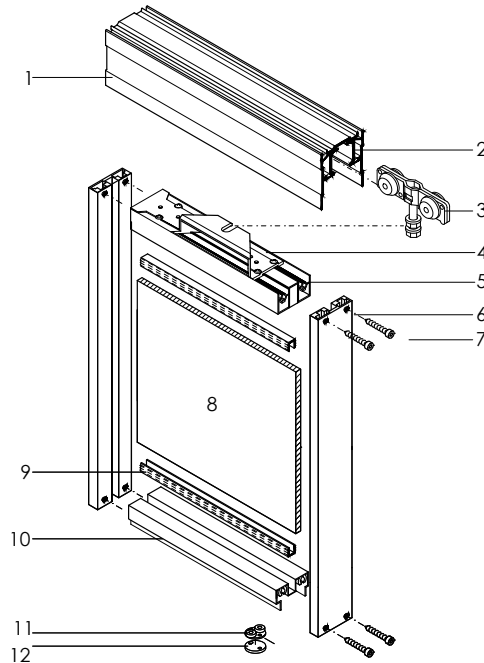
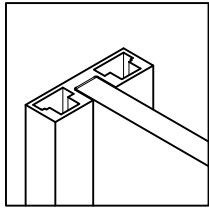

Each sliding door is composed of the following:

- Top track
- 1_ Valance (varies by order)
- 2_ Top track (varies by order)
- Not shown:
- AIR Stopper with brake (2)
- Door
- 3_ AIR roller (2)
- 4_ Fixation for top track (2)
- 5_ Top rail (1)
- 6_ Stile (2)
- 7_ Frame screw (4)
- 8_ Panel (1)
- 9_ Panel gasket (all sides of panel)
- 10_ Bottom rail (1)
- 11_ Ground plate with roller (1)
- 12_ Ground plate without roller (1)

S1200 Section and stile detail / ceiling-mounted

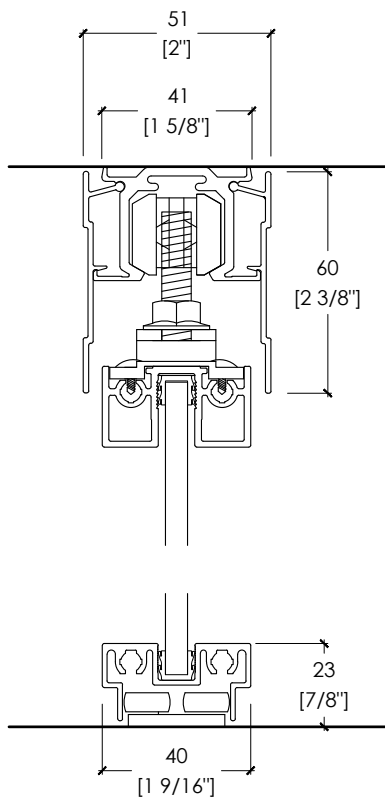

Profile S1200

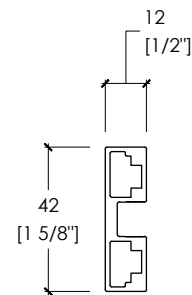

S1200 Stile
12.01.022 - Silver
12.01.066 - Mat black

Finish
Standard: Clear anodized aluminum (silver), Mat black powder coat

Application
Residential / commercial projects

Dimensions
Max size 1219mm x 2743mm [4' x 9']
Max weight 60kg [130lbs]
Panel thickness 4mm [3/16"] to 10mm [3/8"], 10mm without gasket
*Door can not travel past ground plate with roller
*Best used as single door or two bi-parting or bi-pass doors. Can be combined with fixed panels. Not recommended for larger spans
*See Diagrams for recessing top track

SYSTEM DESCRIPTION_ S1200

FIXED PANEL SYSTEM

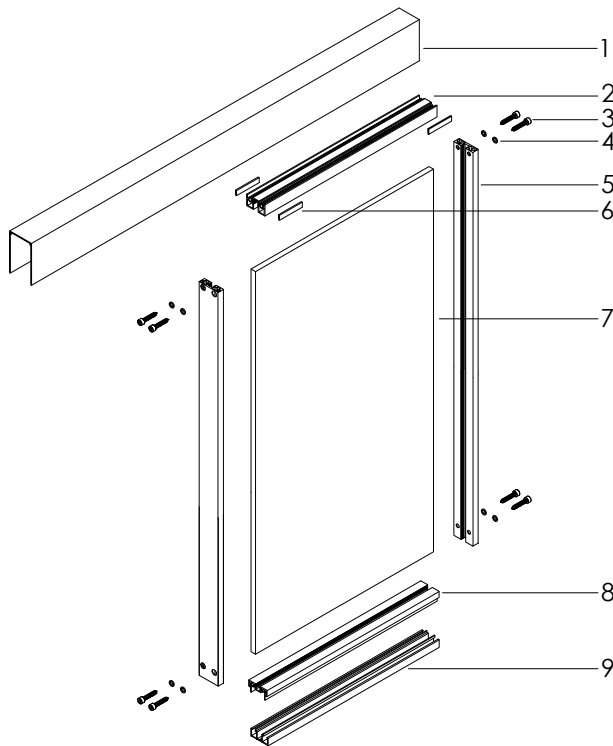

3.1_ Overview

The key features of our made-to-measure system are versatility in customization and quality of our hardware allowing for individual solutions and unparalleled operation. The S1200 Fixed panel is an ideal application for commercial and residential.

Fixed panels can be ordered fully assembled with our standard panel materials or as frame kits to accommodate a panel material of your choosing. Assembly of panels with customer's own materials (COM) is available; please contact Raumplus for more information.

3.2_ Fully assembled fixed panel

Made-to-measure per specifications with the following design parameters:

- _ Maximum height 2743mm [9' - 0"]
- _ Maximum width 1219mm [4' - 0"]
- _ Maximum weight 60kg [130lbs]
- _ Standard finish: Clear anodized aluminum (silver)
- _ Top track, Valance, L-bracket shipped 50mm [2"] over-length for trimming on-site

System components (quantity per door):

- 1_ Top Track (flat shown)
 - 2_ S1200 Top rail
 - 3_ Frame screw
 - 4_ Washer
 - 5_ S1200 Stile
 - 6_ Fuzzy gasket
 - 7_ Panel (varies by order)
 - 8_ S1200 Bottom rail
 - 9_ S1200 Ground connection
- Not shown: Panel gasket

3.3_ Frame kit

Frame kits are made-to-measure per specifications and ready for assembly using customer's own panel material. In addition to the design parameters listed for fully assembled doors, please consider the following:

- _ Minimum panel thickness 4mm [5/32"]
- _ Maximum glass thickness 8mm [5/16"]
- _ Maximum solid panel thickness 10mm [3/8"]

Appropriate panel gasket to be specified when ordering:

- _ 4mm [5/32"]
- _ 5mm [3/16"]
- _ 6mm [1/4"]
- _ 7mm [9/32"]
- _ 8mm [5/16"]

*Gasket not required for solid 10mm [3/8"] material

4_Profiles

4.1_ S1200 fixed Isometric view / ceiling-mounted

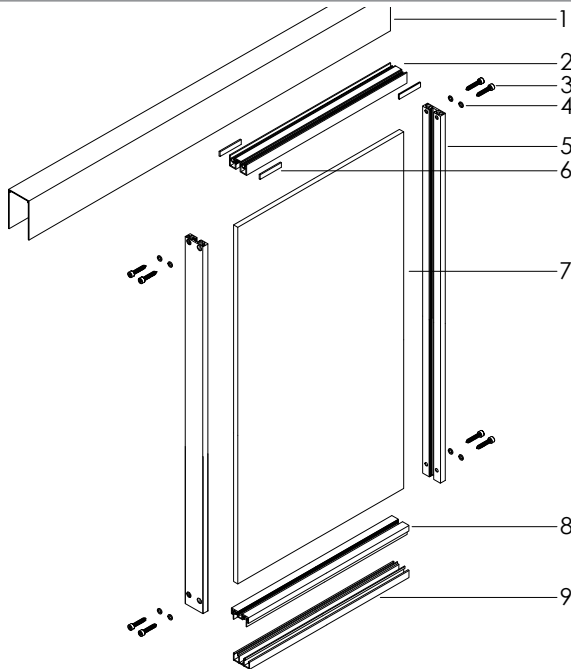
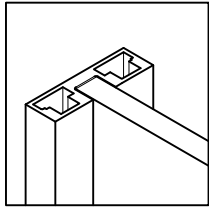

Each fixed panel is composed of the following:

- 1_ Top Track (flat shown)
- 2_ S1200 Top rail
- 3_ Frame screw
- 4_ Washer
- 5_ S1200 Stile
- 6_ Fuzzy gasket
- 7_ Panel (varies by order)
- 8_ S1200 Bottom rail
- 9_ S1200 Ground connection
- Not shown: Panel gasket

S1200 Section of fixed and sliding / ceiling-mounted

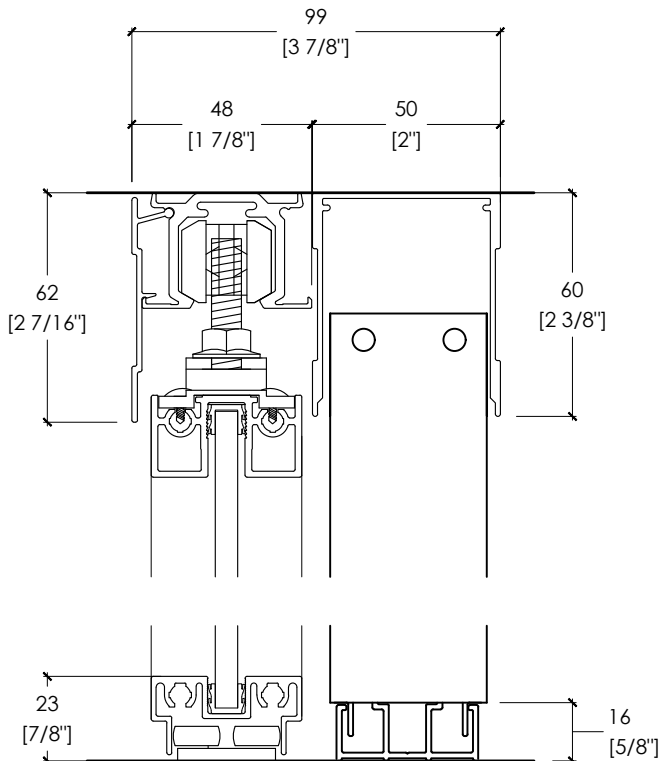

Profile S1200

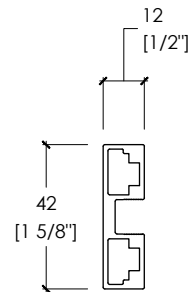

- 12.01.022 - Silver
- 12.01.066 - Mat black
- 12.01.050 - Dark Bronze

Finish
Standard: Clear anodized aluminum (silver), Mat black powder coat

Application
Residential / commercial projects

Dimensions
Max size 1219mm x 2743mm [4' x '9]
Max weight 60kg [130lbs]
Panel thickness 4mm [3/16"] to 10mm [3/8"], 10mm without gasket
*Use fuzzy gasket where the panel meets wall.
*Best used as single panel with single sliding door. Not recommended for larger spans. See S42 S1600 fixed panel for larger spans.
*See Diagrams for recessing top track

SYSTEM DESCRIPTION_ S1200 FIXED

FIXED PANEL SYSTEM

5_ Accessories / 1200 Fixed

5.1_ Ground Connectin profile

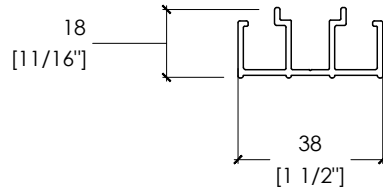
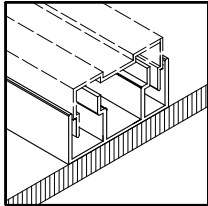

12.30.020 - Silver
 12.30.030. - Dark bronze
 12.30.065 - Mat black

Ground connection profile

Finish
 Standard, Mat black, Dark bronze

Description
 Adjustable base for S1200 fixed panel.

See diagram detail 6.1

6_Detail / 1200 Fixed

6.1_Detail of ground connection

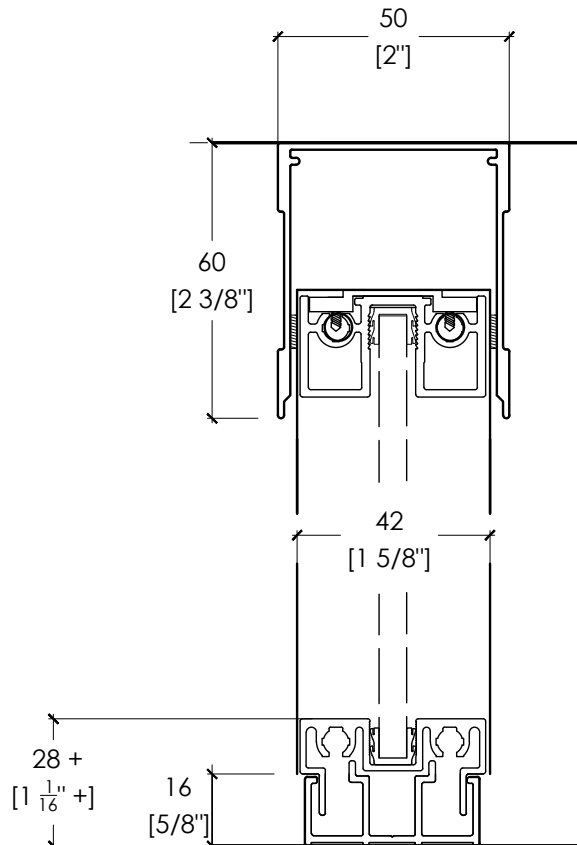

Description:
 Ground plate connection allows the S1200 AIR panel to be fixed, using the ground connection plate. Ground connection plate is affixed to the floor with screws (not provided). S1200 fixed panel can be adjusted up or leveled with with shims placed between the bottom rail and the grund connection plate.

7_ Diagram / S1200 Fixed

7.1_S1200 Fixed and S42 sliding door

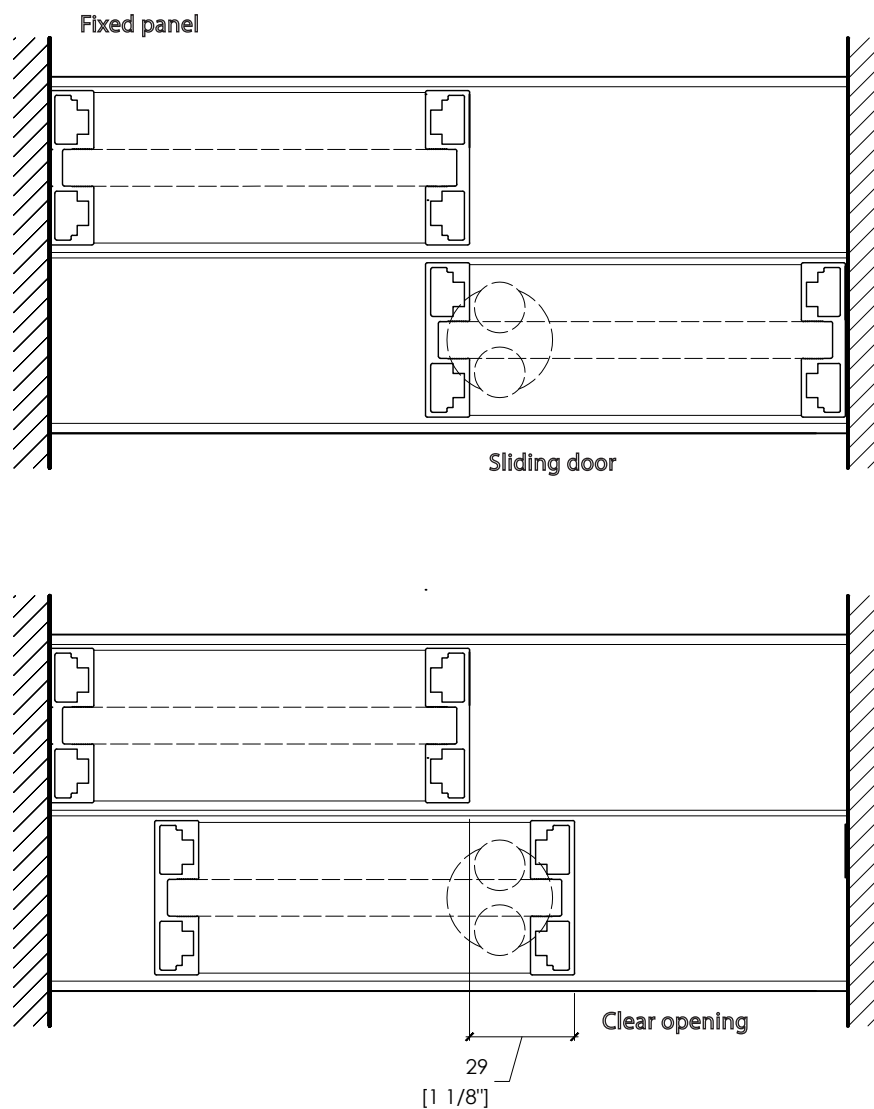

7.2_ 1200 Fixed panel and AIR sliding door alignment notes:

Single fixed panels only. Not suitable for multiple panels, see S1600 panels if longer runs are needed. Use fuzzy gasket where panel meets the wall.

Each AIR door is held in vertical plane at three points: the two top rollers and the ground plate with roller (floor guide).

The door will project into the opening by 29mm [1 1/8"] when in the open position. To fully clear the opening, a door must be oversized with an overlap on one side at a minimum of 58mm [2 5/16"]. For a symmetrical overlap the amount of the overlap must be doubled. These rules apply to single ceiling- or wall-mounted doors.

SYSTEM DESCRIPTION_ S1200 AIR

SLIDING DOOR SYSTEM

8_ Profile finishes

8.1_ Standard finish _ Clear anodized aluminum (silver)

A factory applied finish, anodizing increases wear resistance and gives the surface a smooth matte aluminum appearance. Color for representation purposes only.

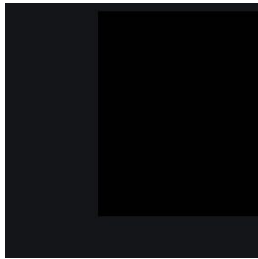
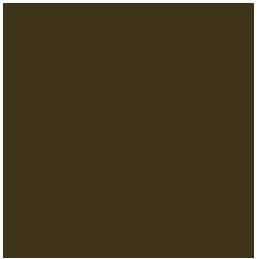
				
Standard finish Clear anodized (silver) Anodized	Black Powder coat Matt finish	Dark Bronze Anodized		

9_ Panels

9.1_ MDF

Medium density fiberboard (MDF) is an engineered wood product made of wood fibers, wax and resin. MDF is an ideal surface for painting, application of direct glue wall-covering, or a base for upholstered panels. Maximum size 1219mm x 2438mm [4'-0" x 8'-0"]. Color for representation purposes only.



MDF
10mm [1/4"]

9.2_ Magnetic marker board

Porcelain enamel coated magnetic marker board is a white dry erase board. Maximum size 1219mm x 2438 [4'-0" x 8'-0"]. Available as single or double sided. Colors for representation purposes only.





6mm [1/4"]

SYSTEM DESCRIPTION_ S1200 AIR

SLIDING DOOR SYSTEM

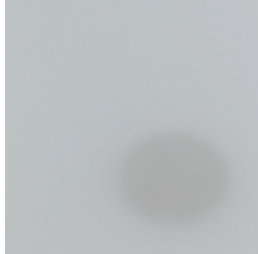

9.3_ Laminated glass

Laminated glass, often referred to as "safety glass", is strong and durable and designed to maintain its integrity in the event of breakage. Maximum size 1219mm x 2743mm [4' x 9']. Colors for representational purposes only. May contain glass manufacturer safety mark

				
Clear 6mm [1/4"]	Diffused white 6mm [1/4"]	Polar white 6mm [1/4"]		

9.4_ Tempered glass

Tempered glass is manufactured to exact size and is stronger than regular glass. If broken the glass shatters into small fragments instead of sharp shards. Maximum size 1219mm x 2743mm [4'-0" x 9'-0"]. Colors for representation purposes only. Manufactures glass bug in corner of glass

				
Clear 6mm [1/4"]	Satin etched 6mm [1/4"]			

9.5_ Mirrored glass

Silver mirror backed with a safety film. Single-sided mirror only, best used for closets. Maximum size 1219mm x 2438mm [4'-0" x 8'-0"]. Colors for representation purposes only.

				
Mirror 5mm [3/16"]				

10_ Top tracks

10.1_ AIR Top track

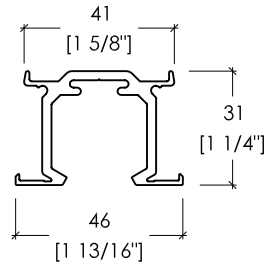
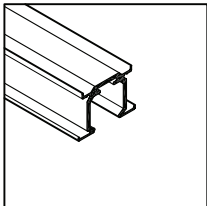

14.55.020 - Silver
14.55.050 - Dark bronze (use with black frames)

AIR Top track

Finish
Standard, Dark bronze

Description
Ceiling- or wall-mounted (add continuous L-bracket and wall-mounted end caps)
Max length 4877mm [16'-0"]
Note: If recessing top track please See diagram detail 8.1

10.2_ AIR Valance

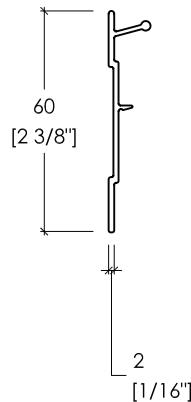
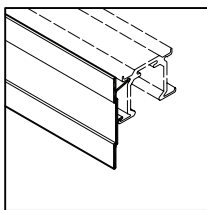

14.50.020 - Silver
14.50.065 - Mat black

AIR Valance

Finish
Standard, Mat black

Description
Use on one or both sides of track
Max length 4877mm [16'-0"]

10.3_ AIR Continuous L-bracket

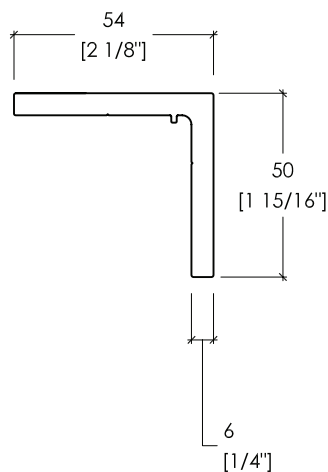
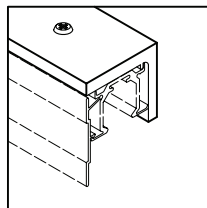

14.54.020

AIR Continuous L-bracket

Finish
Standard

Description
Wall-mounted bracket for AIR Top track
Prepared for assembly, includes track-to-bracket fasteners
Max length 4877mm [16'-0"]
Wall-mount for single doors only

SYSTEM DESCRIPTION_ S1200 AIR

SLIDING DOOR SYSTEM

10.4_ AIR Middle valance

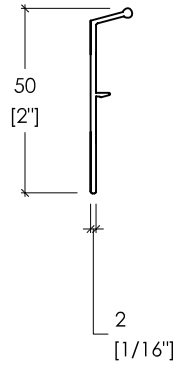
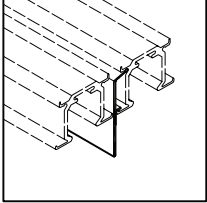

14.53.020 - Silver
12.53.050 - Mat black

AIR Middle valance

Finish
Standard, Mat black

Description
Optional: Use between AIR tracks
Max length 4877mm [16'-0"]

11 Accessories

11.1_ AIR End cap for top track / ceiling-mounted

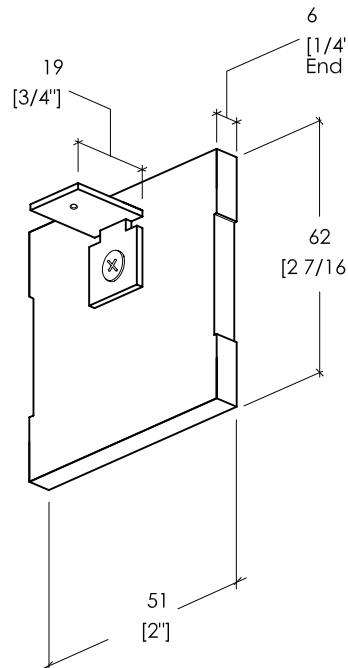
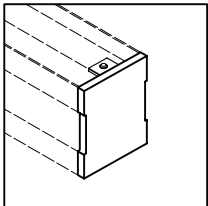

ACC-AIR-ECB - Silver
10.06.293 - Mat black

AIR End cap for single top track /
ceiling-mounted

Finish
Standard, Mat black

Description
For ceiling-mounted top tracks
Includes (1) single end cap
(1) bracket, (1) bracket-to-end cap
screw, and (1) set screw

11.2_ AIR End cap for top track / wall-mounted, left

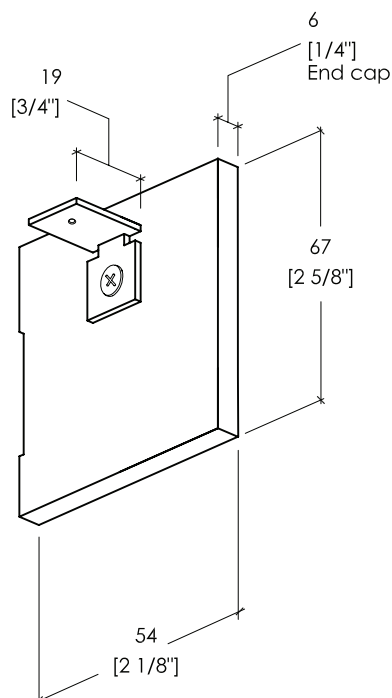
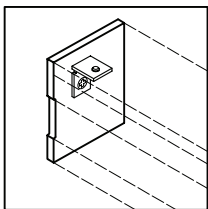

ACC-AIR-ECL - Silver
10.05.298 - Mat black

AIR End cap for top track /
wall-mounted, left

Finish
Standard, Mat black

Description
For wall-mounted top tracks
Includes (1) single end cap
(1) bracket, (1) bracket-to-end cap
screw, and (1) set screw

SYSTEM DESCRIPTION_ S1200 AIR

SLIDING DOOR SYSTEM

11.3_ AIR End cap for top track / wall-mounted, right

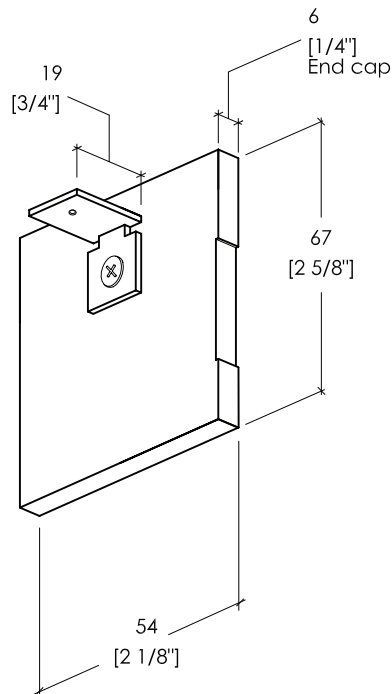
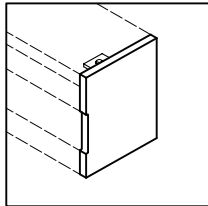

ACC-AIR-ECR - Silver
10.05.299 - Mat black

AIR End cap for top track /
wall-mounted, right

Finish
Standard, Mat black

Description
For wall-mounted top tracks
Includes (1) single end cap,
(1) bracket, (1) bracket-to-end cap
screw, and (1) set screw

11.4_ AIR Stopper with brake

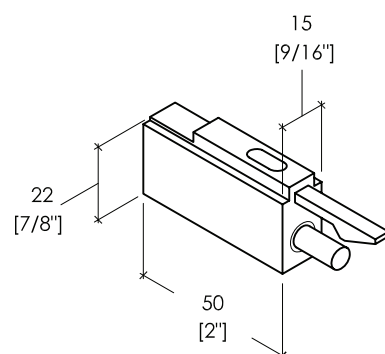
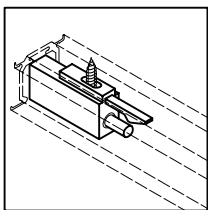



10.05.017

AIR Stopper with brake

Finish
Black plastic

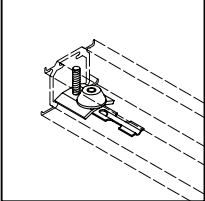
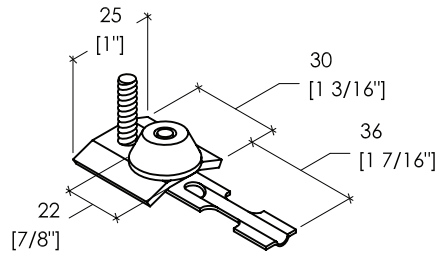
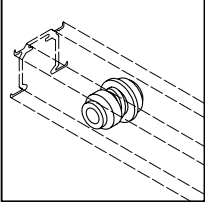
Description
Used for stopping door and
holding in the closed position
Includes 1 mounting screw

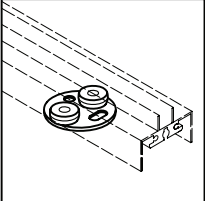
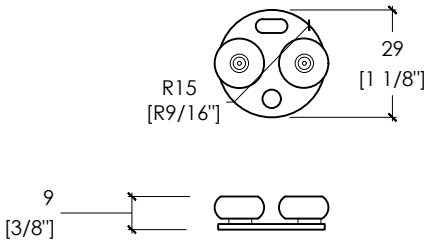
11.5_ AIR Stopper with positioner		
		<p>10.05.015</p> <p>AIR Stopper with positioner</p> <p>Finish Steel and black rubber</p> <p>Description May be used in place of AIR Stopper with brake *Standard stopper for Healthcare</p>
11.6_ AIR Brake		
		<p>10.05.030</p> <p>AIR Brake</p> <p>Finish Black plastic</p> <p>Description Used between top rollers to slow doors over 41 kilo [90 lbs] *Standard brake for Healthcare</p>
11.7_ AIR Ground plate with roller		
		<p>10.06.033</p> <p>AIR Ground plate with roller</p> <p>Finish Steel and nylon</p> <p>Description Concealed under bottom rail, keeps door in line Floor fasteners not included * Door can not travel past ground plate with roller * See 7_ Diagram Alignment</p>

SYSTEM DESCRIPTION_ S1200 AIR

SLIDING DOOR SYSTEM

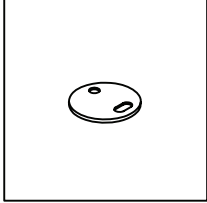
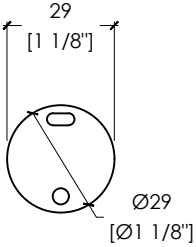
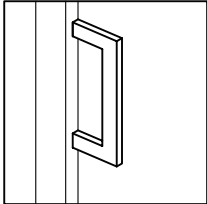
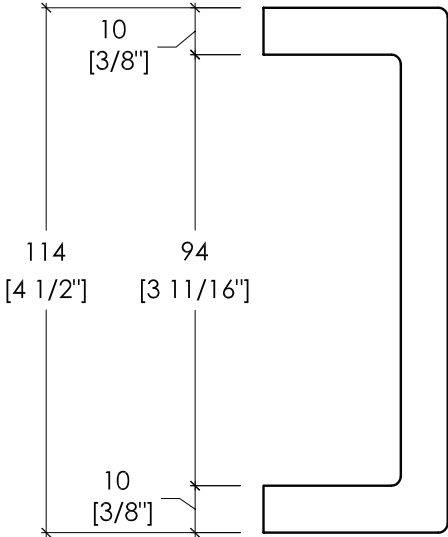
11.8_ AIR Ground plate without roller	
 	10.06.035
	AIR Ground plate without roller
	Finish Steel
	Description Used as shim beneath AIR Ground plate with roller
11.9_ Half rectangle applied handle	
 	10.01.093 - Silver 10.01.105 - Black mat laquer
	Half rectangle applied handle
	Finish Standard
	Description Provided with adhesive backing

11.10_ Retangular handle

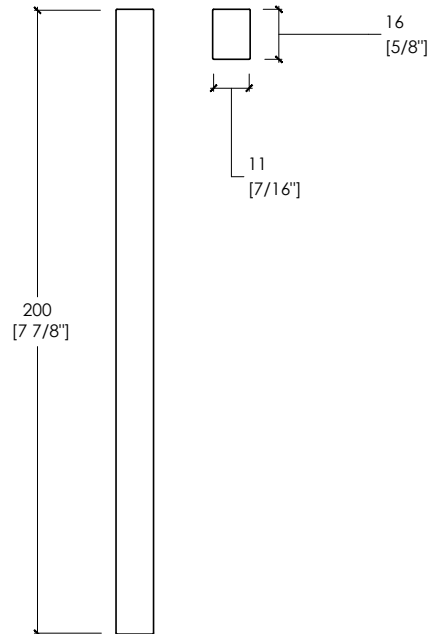
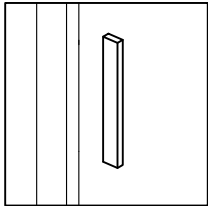

10.01.911 - Silver
10.01.915 - Black mat laquered

Rectangular Handle

Finish
Silver, Black laquer

Description
Provided with adhesive backing

11.11_45° Corner profile

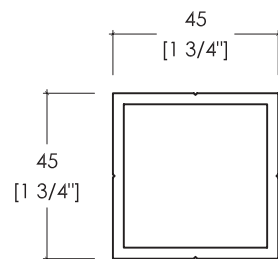
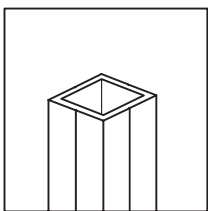

ACC-ST-20

Post

Finish
Standard

Description
Description
on supporting. Use in conjunction
with lock, corner or jamb.
Max length 3048mm [10'-0"]
Includes 3 mounting blocks

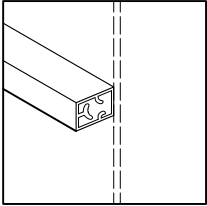
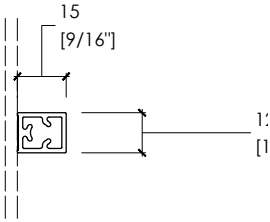
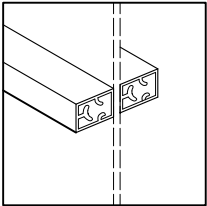
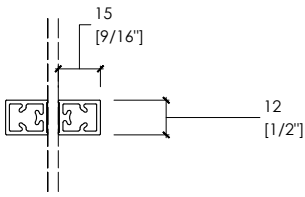
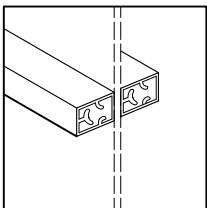
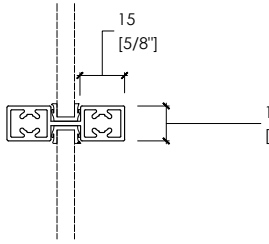
11.12_ Single-sided applied dividing rail	
 	<p>12.22.022 - Silver 12.22.066 - Mat black</p>
	<p>Single-sided applied dividing rail</p> <p>Finish Standard. Mat black</p> <p>Description Provided with adhesive backing Applied divider can be used horizontally or vertically</p>
11.13_ Double-sided applied dividing rail	
 	<p>12.22.022 - Silver 12.22.066- Mat black</p>
	<p>Double-sided applied dividing rail</p> <p>Finish Standard, Mat black</p> <p>Description Provided with adhesive backing Applied divider can be used horizontally or vertically</p>
11.14_ True dividing rail	
 	<p>12.20.020 - Silver 12.20.065 - Mat black</p>
	<p>True dividing rail</p> <p>Finish Standard, Mat black</p> <p>Description Use to partition different materials horizontally or *vertically within a door *Consult Raumplus for vertical partitioning, cannot combine horizontal and vertical true dividers within one door Note: Frame kits not drilled for dividersy</p>

12_Details / Alignment

12.1_ S1200 Alignment / wall-mounted, typical overlap

Typical overlap

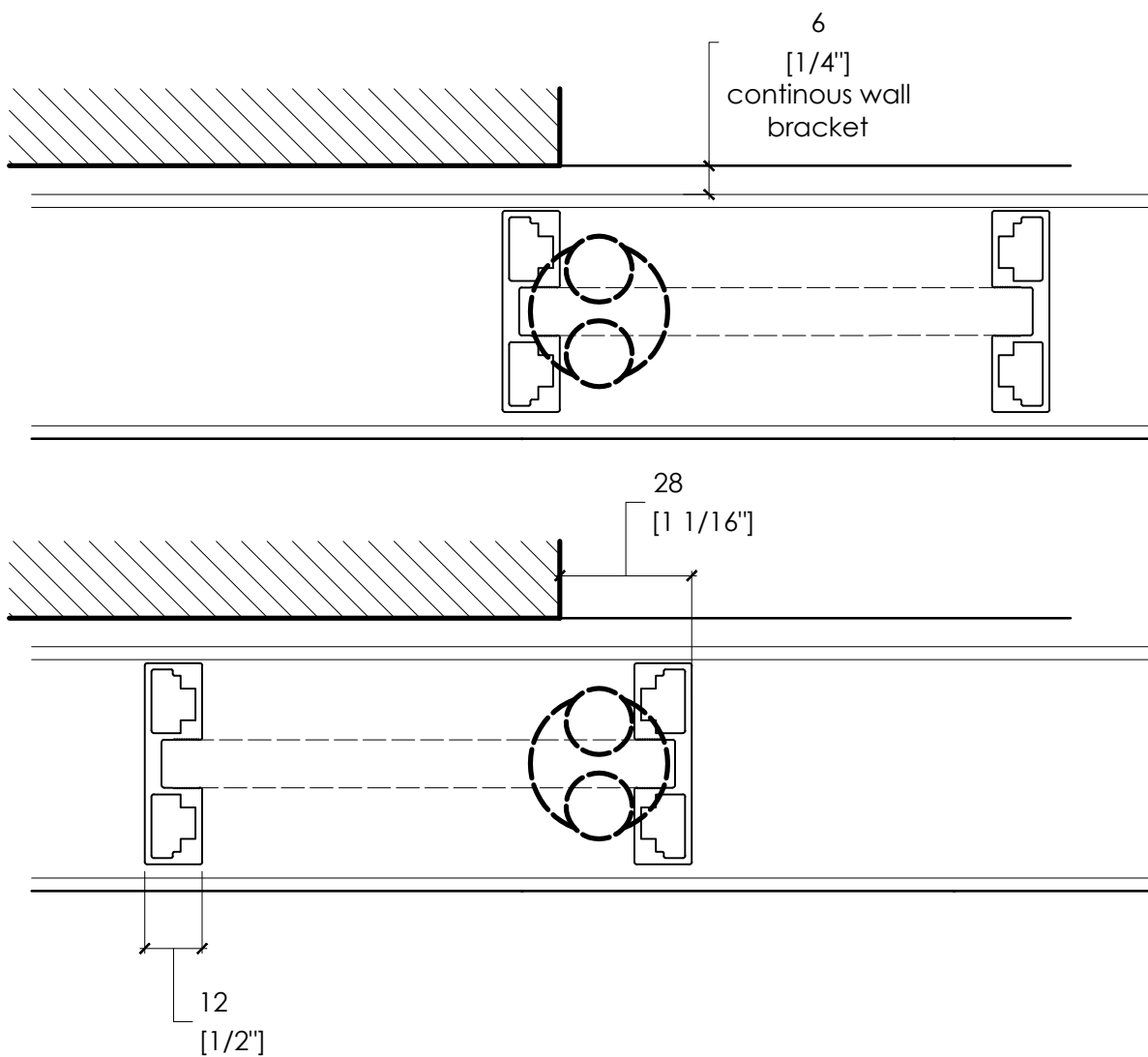

NOTE: Door can not travel past floor guide. To clear opening you must oversize the door.

SYSTEM DESCRIPTION_ S1200 AIR

SLIDING DOOR SYSTEM

12.2_ S1200 Alignment options / wall-mounted, oversized overlap

Oversized overlap

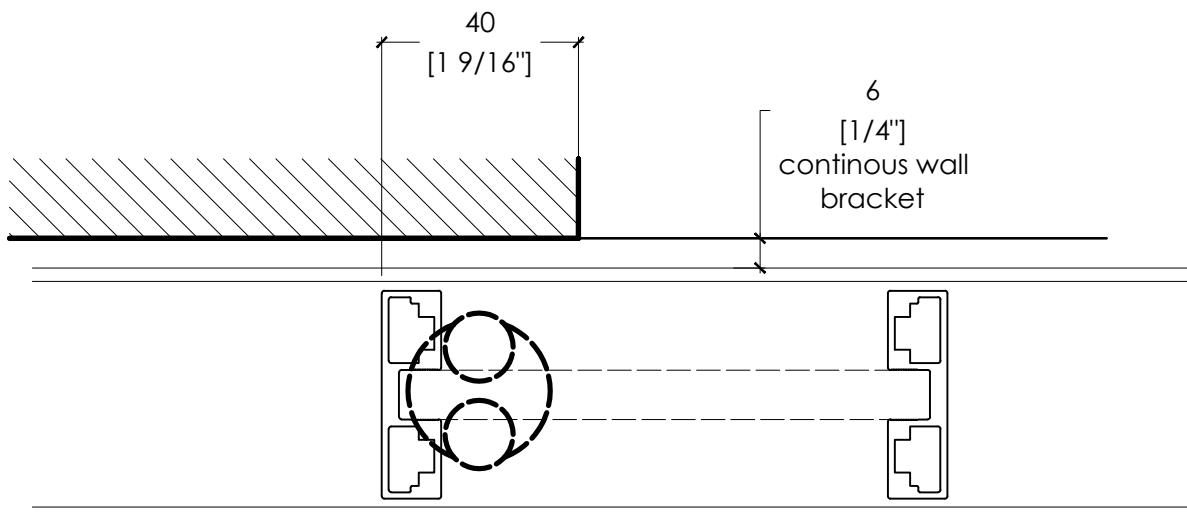

Oversized overlap

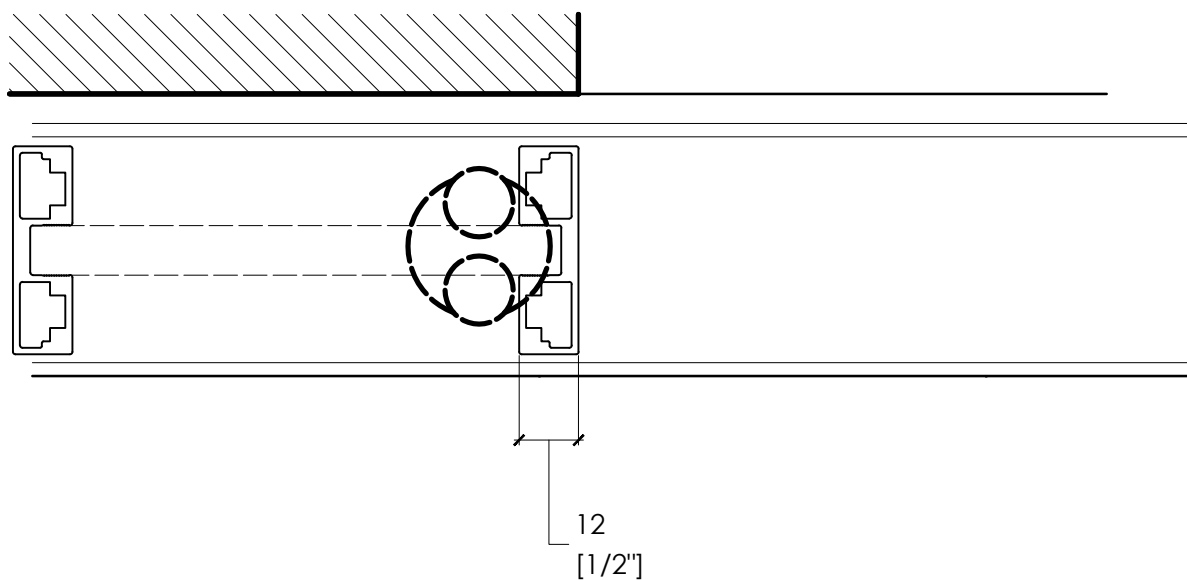

NOTE: Door can not travel past floor guide. To clear opening you must oversize the door.

12.3_ S1200 Alignment / offset bypass

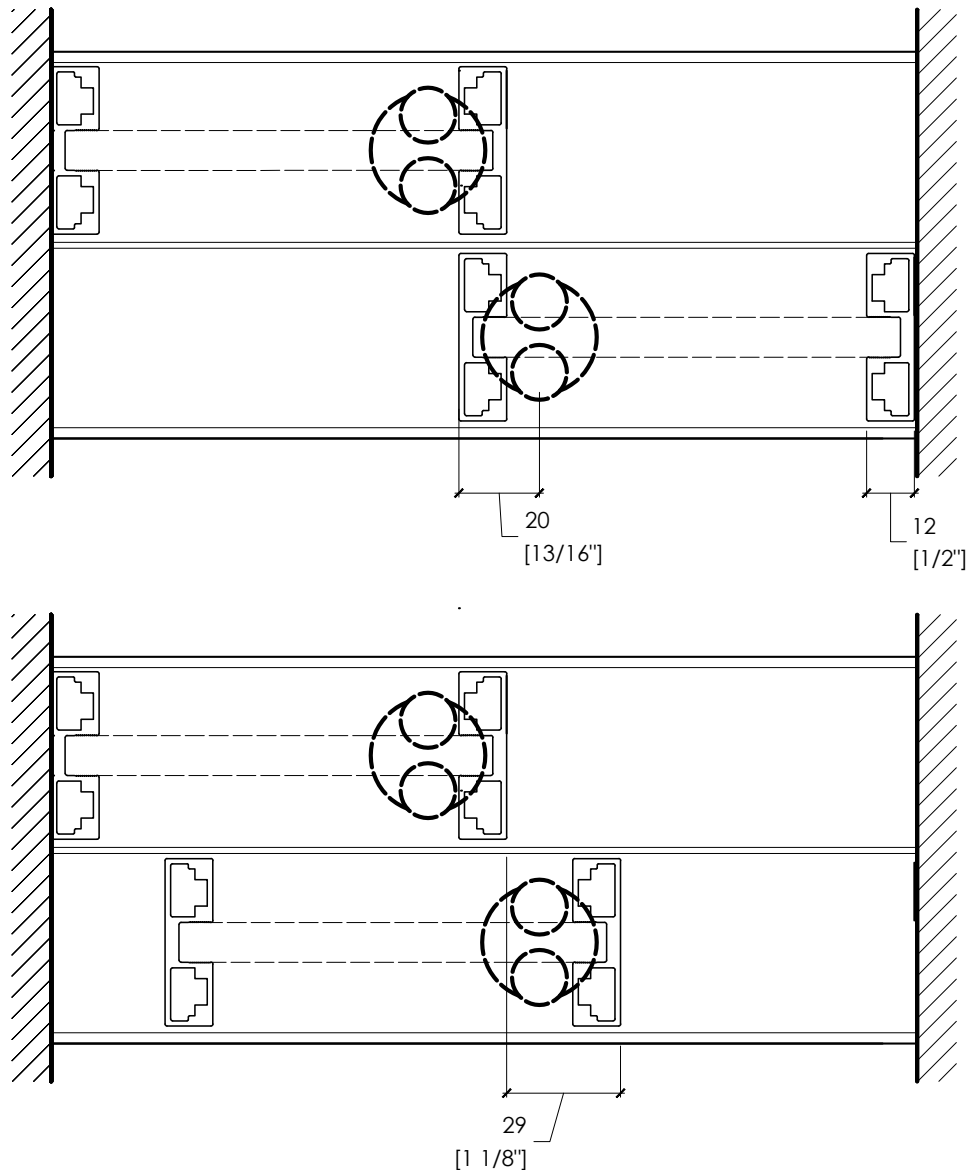

11.6_ S1200 Alignment notes

Each AIR door is held in vertical plane at three points: the two top rollers and the ground plate with roller (floor guide).

For wall-mounted doors, with a typical overlap (one stile each side of opening) the door will project into the opening by 37mm [2 7/16"] when in the open position. To fully clear the opening, a door must be oversized with an overlap on one side at a minimum of 96mm [3 3/4"]. For a symmetrical overlap the amount of the overlap must be doubled. These rules apply to single ceiling- or wall-mounted doors.

If installing as a pocket door with pre-shipped tracks please specify that the rollers ship with the tracks.
The rollers must be in the tracks before the tracks are installed.

SYSTEM DESCRIPTION_ S1200 AIR

SLIDING DOOR SYSTEM

13 Diagrams_Recessed AIR top track

13.1_ Recessed AIR top track

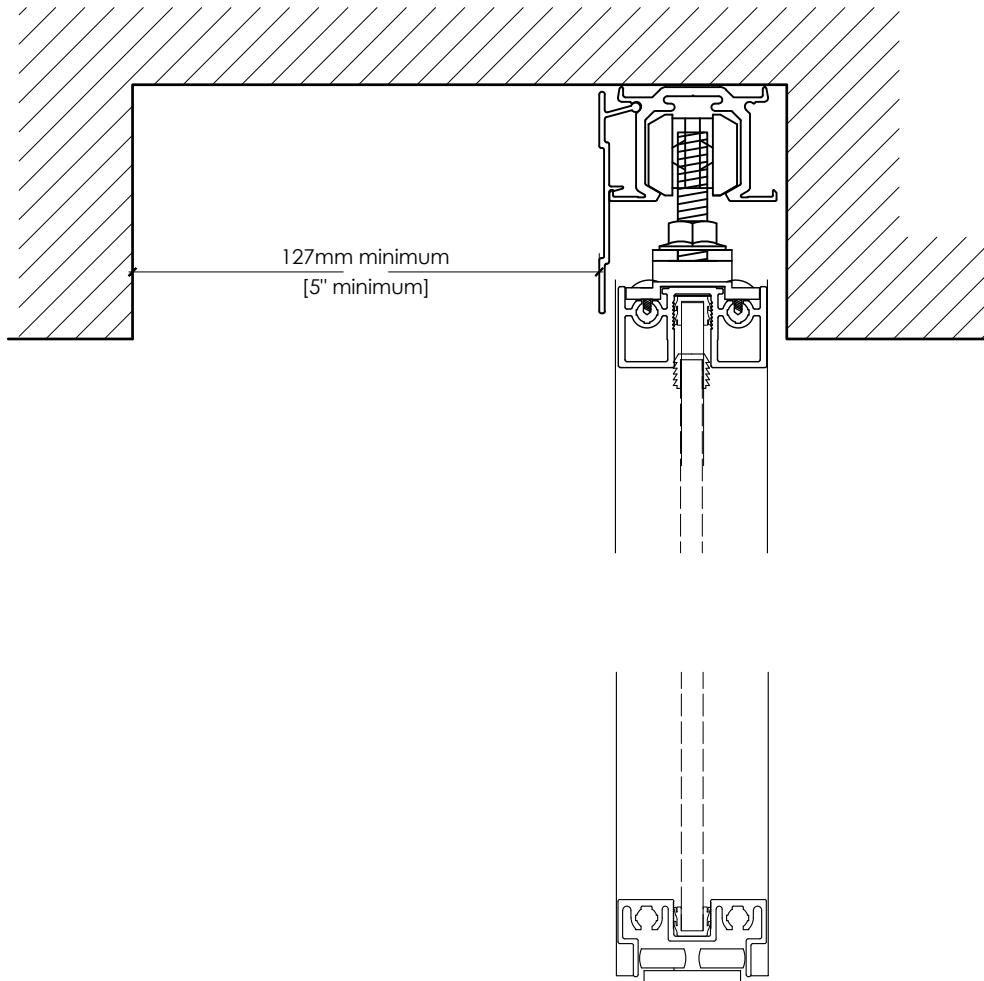

12.1_ Recessed AIR top track notes:

To recess AIR top track, an additional 5" [127mm] is required in the pocket. Additional depth in pocket allows for access to hardware. Adjustment for the AIR door occurs at the nut and bolt, where the top roller is connected to the fixation plate on the top rail. Door will need to be adjusted upon installation and over time. The valance covers the hardware so it is not visible, it is not integral for the operation of the door.

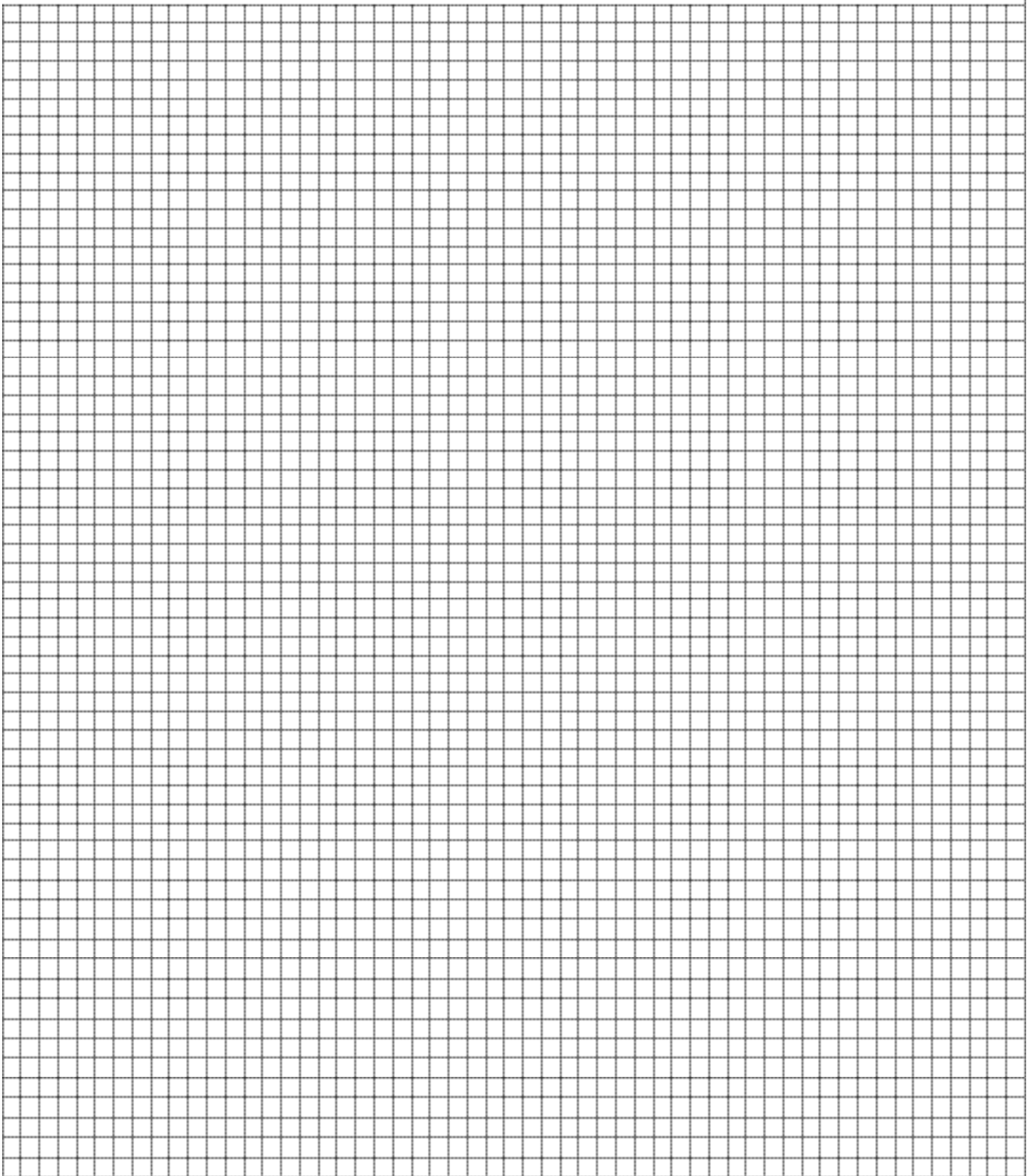

Technical specifications are subject to change. All rights reserved raumplus North America.
Should you have any further questions, please contact your raumplus representative.

Published by:
raumplus North America

USA 866 580 0112